

INDEX OF DRAWINGS

AV.IP.6.0.0	COVER SHEET
AV.IP.6.1.1	LEGENDS, SCHEDULES & RISERS
AV.IP.6.1.2	REMOTE NEO-IP SPLIT SYSTEM RISER
AV.IP.6.2.1	REQUIREMENTS DETAILS #1
AV.IP.6.2.2	REQUIREMENTS DETAILS #2
AV.IP.6.2.3	REQUIREMENTS DETAILS #3 (NEO-IP)
AV.IP.6.2.4	REQUIREMENTS DETAILS #4
AV.IP.6.2.5	REQUIREMENTS DETAILS #5
AV.IP.6.2.5	REQUIREMENTS DETAILS #6 (CollaboratOR1)
AV.IP.6.4.01	FLOOR PLAN & RCP - OR1 AIR
AV.IP.6.4.02	FLOOR PLAN & RCP - OR1 NEO IP
AV.IP.6.5.01	KSIS PROJECT MANAGEMENT REQUIREMENTS

The designs shown on these drawings are planning concept designs only, are not drawn to scale, are not drawn as architectural plans or detailed engineering drawings, do not represent full detail working designs, and do not represent or incorporate detail structural or engineering analysis. These drawings are provided "as-is" and are intended to be used only as planning concept guides, and not for any other purpose. All warranties and representations of any kind, whether expressed, implied or statutory, including warranties of merchant ability and fitness for a particular purpose, with regard to the designs or drawings by a recipient in any manner other than as herein intended. Any recipient of these drawings hereby agrees to indemnify Karl Storz against any and all claims, liability, damages and costs (including attorneys' fees) arising out of, or resulting from, any use of these designs or drawings other than as herein intended.

KARL STORZ ENDOSCOPY-AMERICA
STAFFORD, TEXAS

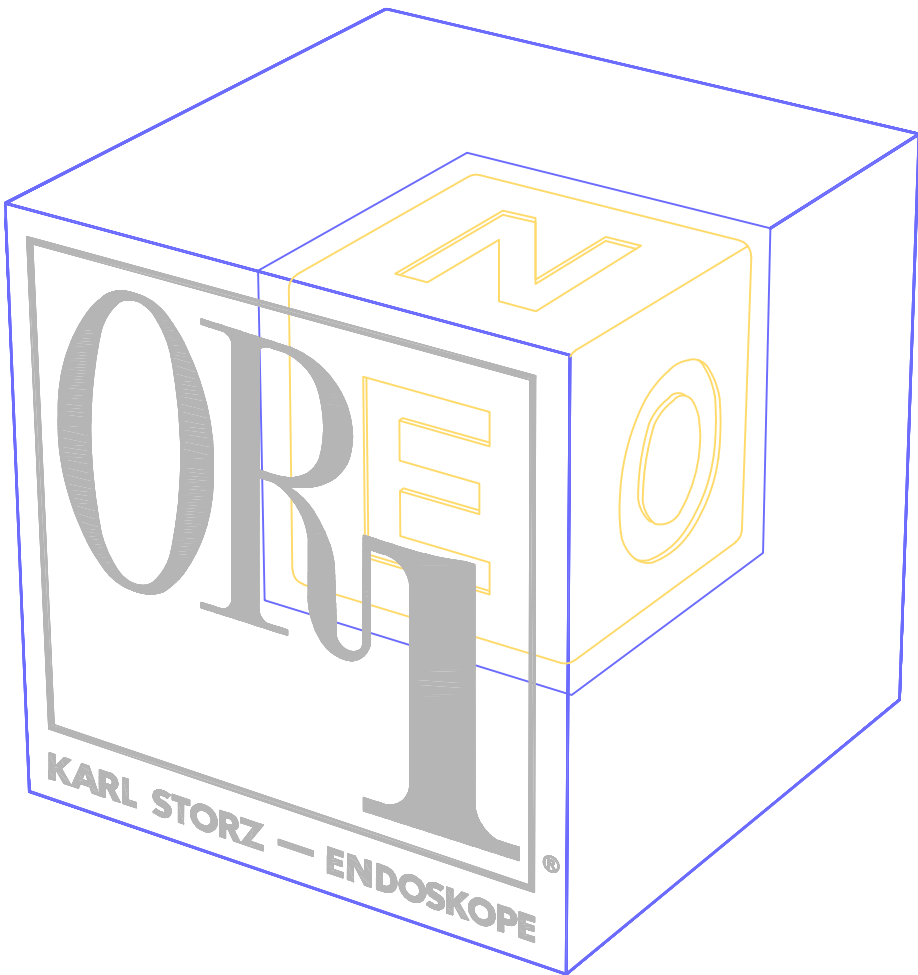

TYPICAL HOSPITAL
CITY, STATE
ROOM NUMBER

FACILITY REQUIREMENTS
OR1® AIR & NEO IP SERIES SYSTEM



13803 N. PROMENADE
STAFFORD, TX 77477-5753
PH. 281.566.4100
FX. 281.566.4109

FOR COORDINATION ONLY - NOT FOR CONSTRUCTION

TYPICAL HOSPITAL (NOT PROJECT SPECIFIC)
OR1® NEO SERIES SYSTEM
FACILITY REQUIREMENTS:
COVER SHEET
CONFIDENTIAL - NOT TO BE DISTRIBUTED OUTSIDE OF KSEA, INC.
This drawing is the property of KARL STORZ ENDOSCOPY, and is not to be reproduced or copied in whole or in part. It is only to be used for the project and site specifically. Identified herein and is not to be used on any other project. It is to be returned upon request.

REVISIONS:	DATE:
Δ REV. 0:	3/31/2022
(INITIAL RELEASE)	

DRAWN BY:	SSatre
ENG. BY:	
DATE:	00/00/2022
FILE NAME:	GENERIC_NEO_FACILITY_DRAWINGS.DWG
PLT SC	N.T.S
Generic_NEO_Facility_Drawings	

CHK. BY:	DATE:

JOB NO.
GENERIC

DRAWING NUMBER
AV.IP.
6.0.0
01 OF 12

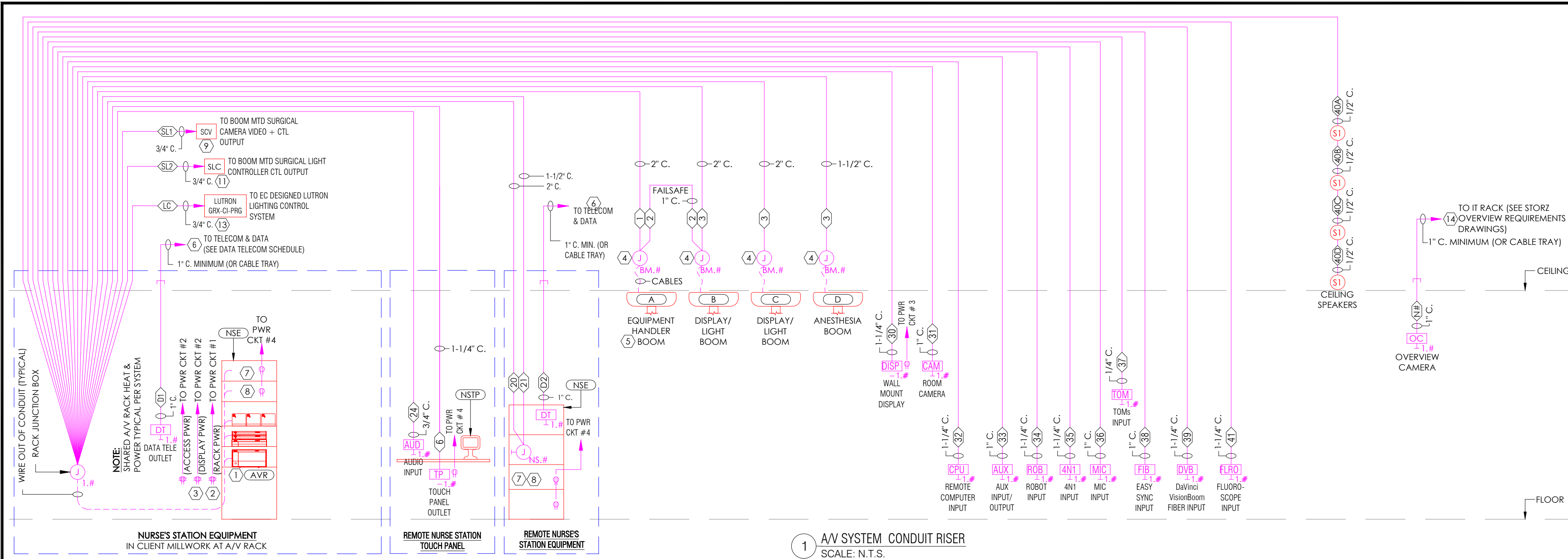

NOTE:
1. MAXIMUM 70 FT. CONDUIT LENGTH (100 FT. CABLE LENGTH) ON RUNS FROM RACK TO OR EQUIPMENT.
2. DEDICATED 4 mm² - 6 mm², MAX Ø 5.9 mm GROUND WIRE FROM GROUND PANEL TO A/V RACK PROVIDED BY C.C. (NOT STORZ).
3. A/V EQUIPMENT REQUIRES ADEQUATE AIR EXCHANGE PASSIVE OR ACTIVE FOR **NOMINAL TEMPERATURE OF 90° FAHRENHEIT**.

JUNCTION BOX SCHEDULE			
J-BOX #	SIZE	TYPE (NOTE 1 BELOW)	MOUNTING/COMMENT (NOTE 2 BELOW)
J-1.#	12" X 12" X 4" D (MINIMUM)	NEMA 1, SCREW COVER, EQUAL TO HOFFMAN A-SE SERIES	WALL, FLUSH, SEE DETAIL
J-BM.#	8" X 8" X 4" D	NEMA 1, SCREW COVER, EQUAL TO HOFFMAN A-SE SERIES	ABOVE CEILING, ADJACENT TO BOOM
J-MP.#	12" X 12" X 6" D	NEMA 1, SCREW COVER, EQUAL TO HOFFMAN A-SE SERIES	WALL, FLUSH, SEE DETAIL
J-NS.#	8" X 8" X 4" D	NEMA 1, SCREW COVER, EQUAL TO HOFFMAN A-SE SERIES	WALL, FLUSH, FOR NSE, COORD. WITH MILLWORK

JUNCTION BOX SCHEDULE NOTES:
1. ALL BOXES AND COVER PLATES ARE PROVIDED BY THE CLIENTS CONTRACTOR UNLESS NOTED OTHERWISE.
2. MOUNTING REQUIREMENTS SHOWN ARE THE DEFAULT REQUIREMENTS UNLESS OTHERWISE NOTED/DETAILED.

POWER & HEAT LOAD SCHEDULE PER SYSTEM (1 SYSTEMS PER A/V RACK)						
CIRCUIT REF. #	VOLTS	AMP	DESTINATION	LOAD	ELECT LOAD (WATTS)	HEAT LOAD (BTU)
1	120 VAC	20	RECEPTACLE @ A/V RACK / Collaborator 4	A/V RACK(IP)	1159.00	3954.51
1	120 VAC	20	RECEPTACLE @ NURSE STATION	OR1 AIR	981	3347.17
1	120 VAC	20	RECEPTACLE @ NURSE STATION	AV RACK(BR4K)	72.25	246.52
2	120 VAC	20	RECEPTACLES @ DISPLAY BOOM(S)	(3)BOOM DISPLAYS	501	1709.41
3	120 VAC	20	RECEPTACLES @ WALL DISPLAY(S)	(2)LCD	346	1180.55
4	120 VAC	20	RECEPTACLES @ NSTP & AIDA	(1)NSTP/AIDA/PRINTER	898	3063.98

POWER SCHEDULE NOTES:
1. ALL A/V POWER CIRCUITS MUST COME FROM THE SAME ELECTRICAL PANEL THAT PROVIDES POWER TO THE PATIENT VICINITY OUTLETS, BOOMS AND SERVICE COLUMNS
2. ALL A/V POWER CIRCUITS ARE TO HAVE FULL SIZE DEDICATED NEUTRALS.
3. CIRCUITS SHOWN ARE FOR DEDICATED USE WITH STORZ EQUIPMENT ONLY
4. A/V CIRCUITS SHALL BE ON THE SAME PHASE AND FEED FROM THE SAME ISOLATED POWER PANEL THAT FEEDS ALL THE PATIENTS CRITICAL EQUIPMENT.
5. CIRCUIT BREAKER TRIP CURVE CHARACTERISTICS SHALL BE EQUAL TO OR GREATER THAN SQUARE-D QO-B-HM SERIES.

DATA TELECOM SCHEDULE (CLIENT CABLING BY C.C.)			
RUN #	LOCATION	C.C. TO PROVIDE	
D1	DT OUTLET AT RACK	(4) HOSPITAL NETWORK (FOR STORZ NETWK EQUIP/VIDEO CONF.)	RJ-45
D2	DT OUTLET AT NSE	(2) HOSPITAL NETWORK (FOR STORZ NETWK EQUIP/VIDEO CONF.)	RJ-45

DATA TELECOM SCHEDULE NOTES:
1. CONNECTIONS REQUIRED FOR VIDEOCONFERENCING AND/OR VIDEO STREAMING .

The designs shown on these drawings are planning concept designs only, are not drawn to scale, are not drawn as architectural plans or detailed engineering drawings, do not represent full detail working designs, and do not represent or incorporate detail structural or engineering analysis. These drawings are provided "as-is" and are intended to be used only as planning concept guides, and not for any other purpose. All warranties and representations of any kind, whether expressed, implied or statutory, including warranties of merchant ability and fitness for a particular purpose, with regard to the designs or drawings by a recipient in any manner other than as herein intended. Any recipient of these drawings hereby agrees to indemnify Karl Storz against any and all claims, liability, damages and costs (including attorneys' fees) arising out of, or resulting from, any use of these designs or drawings other than as herein intended.

SHEET NOTES	
1	A/V EQUIPMENT RACK (AVR): RACK MAYBE SUPPLIED BY KARL STORZ BASED ON SYSTEM SOLD.
2	RACK POWER RECEPTACLE: LOCATED AT A/V RACK FOR STORZ RACK POWER AND ASSOCIATED AV EQUIPMENT. RACK RECEPTACLE TO BE PROMINENTLY LABELED ' RACK POWER '.
3	DISPLAY POWER RECEPTACLE AT RACK: LOCATED AT RACK FOR BOOM MOUNTED DISPLAYS AND/OR TOUCH PANELS WITH REMOTE 24VDC POWER SUPPLIES. DISPLAY RECEPTACLE SHALL BE PROMINENTLY LABELED ' DISPLAY POWER '.
4	BOOM JUNCTION BOXES: MOUNT ADJACENT TO BOOM SUPPORT STRUCTURE. PROVIDE CEILING ACCESS BELOW BOXES IF CEILING SPACE AT BOX LOCATION IS INACCESSIBLE AFTER FINISHED CEILING IS INSTALLED. SEE BOOM JUNCTION BOX DETAIL.
5	POWER CIRCUITS & RECEPTACLES IN EQUIPMENT HANDLER BOOMS: STORZ EQUIPMENT TYPICALLY REQUIRES (2)20A, 120VAC CIRCUITS WITH (4) RECEPTACLES EACH. SEE BOOM SUPPLIER DRAWINGS FOR ELECTRICAL REQUIREMENTS AT BOOMS.
6	DATA/TELEPHONE BOX: DATA AND TELECOM CONNECTIVITY REQUIRED FOR STORZ INTEGRATION. PROVIDE SUITABLE IDENTIFICATION LABELS. SEE TELECOM/DATA SCHEDULE FOR REQUIREMENTS.
7	NURSE STATION BOXES: BOXES SHOWN ARE TO BE INTEGRATED WITH THE MILLWORK. SEE NURSE STATION DETAIL. VERIFY LOCATIONS WITH STORZ PRIOR TO INSTALLATION. C.C. TO PROVIDE ACCESS HOLES/WIREWAYS IN MILLWORK FOR CABLES.
8	NURSE STATION EQUIPMENT POWER: PROVIDE AT LEAST THE QUANTITY OF DUPLEX RECEPTACLES IN NSE CABINET FOR STORZ EQUIPMENT AND COMPUTERS AS SHOWN ON STORZ NURSE STATION EQUIPMENT (NSE) DETAIL.
9	BOOM MOUNTED SURGICAL LIGHT CAMERA: CONDUIT FROM THE SURGICAL LIGHT CAMERA CONTROL UNIT (VIDEO/CONTROL) OUTPUTS TO THE NURSE STATION IS REQUIRED FOR STORZ INTEGRATION. VERIFY OUTPUT LOCATION WITH SURGICAL LIGHT CAMERA CONTROL UNIT SUPPLIER.
10	ROOM LIGHTING CONTROL: DEDICATED SINGLE LUTRON GRX LIGHTING CONTROLLER, WITH 6 ZONES. LIGHTING CONTROL EQUIPMENT & DESIGN BY CLIENTS CONTRACTOR(NOT STORZ).
11	BOOM MOUNTED SURGICAL LIGHTS: CONDUIT FROM THE SURGICAL LIGHT CONTROLLER TO THE NURSE STATION (STORZ COMPUTER LOCATION) IS REQUIRED FOR STORZ REMOTE CONTROL OF SURGICAL LIGHTING.
12	MULTIPLE TOUCH PANEL HUB (MTPH): REQUIRED FOR SYSTEMS REQUIRING ADDITIONAL TOUCH PANELS. (3)EXTRA TOUCH PANELS CAN BE ADDED FOR A MAX OF (4)TOUCH PANELS PER SYSTEM. (MTPH SUPPLIED BY STORZ)
13	CC OUTLET CONDUIT: PROVIDE CONDUIT FROM OUTLET TO CONDUIT /CABLE TRAY IN CORRIDOR FOR STORZ CompleteView CAMERA SYSTEM. SEE STORZ CompleteView SYSTEM REQUIREMENTS DRAWINGS FOR C.C. REQUIREMENTS.

GENERAL NOTES & ABBREVIATIONS	
GENERAL NOTES: 1. THESE DRAWINGS ARE FOR REQUIREMENTS REFERENCE ONLY. NOT FOR CONSTRUCTION. 2. SUPPLY AND INSTALLATION OF ALL CONDUIT, POWER CIRCUITS, BACK BOXES, ELECTRICAL DEVICES, ELECTRICAL WIRING IS TO BE PROVIDED BY THE CLIENTS ELECTRICAL CONTRACTOR UNLESS NOTED OTHERWISE. 3. C.C. TO PROVIDE ADEQUATE VENTILATION FOR NOMINAL A/V EQUIPMENT TEMPERATURE OF 90° FAHRENHEIT.	
GENERAL CONDUIT & BOX NOTES 1. C.C. TO PROVIDE BLANK COVER PLATES FOR ALL JUNCTION BOXES. 2. CC. TO PROVIDE CABLE PROTECTION BUSHINGS ON ALL BOXES AND CONDUIT STUB-OUTS. 3. ALL CONDUIT TO BE MINIMUM 3/4" METALLIC U.N.O. 4. MAXIMUM LENGTH FOR FLEX CONDUIT IF USED FOR STORZ AV CABLING IS 25 FEET. 5. CONDUITS TO BE DE-BURRED, CLEANED, CAPPED, AND FURNISHED WITH NYLON PULL ROPE. 6. CONDUIT STUB-OUTS, JUNCTION BOXES, AND OUTLETS SHALL BE SUITABLY LABELED FOR IDENTIFICATION OF FUNCTION, J-BOX #, AND/OR CONDUIT NUMBER.	
ABBREVIATIONS: A.F.F. = ABOVE FINISHED FLOOR A/R = AS REQUIRED B.C.P. = BLANK COVER PLATE B.F.C. = BELOW FINISHED CEILING C.C. = CLIENTS CONTRACTOR (NOT BY KARL STORZ) C.P. = COVER PLATE CRE = CONTROL ROOM EQUIPMENT HT. = HEIGHT I.G. - ISOLATED GROUND (TECHNICAL GROUND) I.P. = ISOLATED PWR. (UNGROUND NEUTRAL PWR)	
NSE = NURSE STATION EQUIPMENT NSTP = NURSE STATION TOUCH PANEL N/A = NOT APPLICABLE N/R = NOT REQUIRED N/U = NOT USED O.R. = OPERATING ROOM RJB = RACK JUNCTION BOX S.F. = STERILE FIELD T.B.D. = TO BE DETERMINED U.N.O. = UNLESS NOTED OTHERWISE	

SYMBOL LEGEND			
SYMBOL	DESCRIPTION	BOX (NOTE 1 BELOW)	MOUNTING/COMMENT
AP	CEILING ACCESS PANEL	(NOTE 3 BELOW)	FOR REQUIRED ACCESS TO BOXES ABOVE CLG.
#	EQUIPMENT LABEL		DENOTES EQUIPMENT AT LOCATION SHOWN
<#>	CONDUIT OR CABLE RUN #		CONDUIT/CABLE RUN REFERENCE #
—	CONDUIT STUB OUT		CONDUIT STUB OUT WITH BUSHING
J	JUNCTION BOX	SEE J-BOX SCHEDULE	SEE J-BOX SCHEDULE
4NT+	AUXILIARY INPUT BOX	RACO 263 DATA-BOX, TR-1G	WALL, FLUSH, RECEPTACLE HT. SEE 6/AV.EN.6.21
AUD+	AUDIO INPUT BOX	4S, TR-1G, 1G-B.C.P.	WALL, FLUSH, ABOVE COUNTERTOP
AUX+	AUXILIARY INPUT/OUTPUT BOX	4S, TR-1G, 1G-B.C.P.	WALL, FLUSH, RECEPTACLE HT.
CAM+	HD RM CAMERA BOX(MINIRAY)	4S, TR-1G, 1G-B.C.P.	WALL, FLUSH, SEE DETAIL 11/AV.EN.6.21
CPU+	COMPUTER INPUT BOX	RACO 263 DATA-BOX, TR-1G	WALL, FLUSH, RECEPTACLE HT. SEE 6/AV.EN.6.21
DISP+	DISPLAY BOX	4S, TR-1G, 1G-B.C.P.	WALL, FLUSH, SEE DETAIL 15/AV.EN.6.21
DISP2+	DISPLAY BOX(COLLABORATOR)	SnapAV 14x14 VersaBox	WALL, FLUSH, SEE DETAIL FOR Collaborator DISPLAY
DT+	DATA/TELEPHONE BOX	A/R, TYPICAL 1G	WALL, FLUSH, RECEPTACLE HT. (NOTE 6)
MIC+	MICROPHONE BOX	4S, TR-1G, 1G-B.C.P.	WALL, FLUSH, RECEPTACLE HT.
OC+	CompleteView CAMERA OUTLET	A/R, TYPICAL 1G	WALL, FLUSH, 12" B.F.C. (NOTE 8)
CC	CompleteView CAMERA OUTLET	A/R, TYPICAL 1G	CEILING, FLUSH, SEE DETAIL
POD+	iPOD EXTENSION OUTLET	4S, TR-2G, 2G-B.C.P.	WALL, FLUSH, TYPICAL 4" BELOW COUNTERTOP
ROB+	ROBOT INPUT BOX	6x6x4, COVER W/1G-B.C.P.	WALL, FLUSH, RECEPTACLE HT. SEE DETAIL
S1	CEILING SPEAKER	CUTOUT (PER TEMPLATE)	HOLE CUT IN SHEETROCK BY C.C.(NOT STORZ), CUTOUT TEMPLATE PROVIDED BY STORZ.
SLC+	SURGICAL LIGHT CCU OUTPUT	SEE VENDER SPECIFICATIONS	COORDINATE W/SURGICAL LIGHT VENDER
TOM+	TOMS INPUT BOX	4S, TR-2G, 2G-B.C.P.	WALL, FLUSH, SWITCH HT.
TP+	TOUCH/PANEL BOX	4S, TR-1G, 1G-B.C.P.	WALL, FLUSH, TYPICAL 4" BELOW COUNTERTOP
⊕	DUPLEX POWER RECEPTACLE	A/R, TYPICAL 1G	WALL, FLUSH, RECEPTACLE HT.
⊕	QUAD POWER RECEPTACLE	A/R, TYPICAL 2G	WALL, FLUSH, RECEPTACLE HT.

SYMBOL LEGEND NOTES	
1. ALL BOXES AND COVER PLATES ARE PROVIDED BY THE CLIENTS CONTRACTOR UNLESS NOTED OTHERWISE. 2. MOUNTING REQUIREMENTS SHOWN ARE THE DEFAULT REQUIREMENTS UNLESS OTHERWISE NOTED/DETAILED. 3. BOXES/OUTLETS/RECEPTACLES LOCATED ABOVE THE CEILING MUST BE WITHIN 18 INCHES OF THE CEILING AND BE ACCESSIBLE FROM THE SPACE BELOW. CLIENT / C.C. TO PROVIDE SUITABLE CEILING ACCESS PANELS AT DEVICE LOCATIONS. (ACCESS PANELS EQUAL TO WILLIAMS BROS. MODEL WBFR0). 4. "RECEPTACLE HEIGHT" DENOTES MOUNTING HEIGHT OF REGULAR RECEPTACLES SPECIFIED FOR THIS PROJECT. 5. "SWITCH HEIGHT" DENOTES MOUNTING HEIGHT OF REGULAR SWITCHES SPECIFIED FOR THIS PROJECT. 6. SEE DATA/TELECOM SCHEDULE FOR CLIENT CABLING REQUIREMENTS. 7. SEE STORZ STREAMCONNECT SYSTEM REQUIREMENTS FOR CLIENT REQUIREMENTS. 8. SEE STORZ CompleteView SYSTEM REQUIREMENTS FOR CLIENT REQUIREMENTS. 9. C.C. TO SUSPEND SPEAKER ASSEMBLY FROM STRUCTURE ABOVE CEILING. 10. BOX/OUTLET NUMBER: "1.#" FIRST NUMBER DENOTES BOX/OUTLET NUMBER, "#" DENOTES ROOM SEQUENCE. BOX TYPES: 1G = SINGLE GANG METALLIC BACK BOX (MINIMUM DEPTH 3-1/2"). 2G = 2 GANG METALLIC BACK BOX (MINIMUM DEPTH 3-1/2"). 4G = 4 GANG METALLIC BACK BOX (MINIMUM DEPTH 3-1/2"). 4S = 4" X 4" SQUARE BACK BOX WITH TRIM RING AS NOTED (MINIMUM DEPTH 3-1/2"). TR-1G = TRIM RING FOR MOUNTING 1 GANG PLATE. TR-2G = TRIM RING FOR MOUNTING 2 GANG PLATE. #G-B.C.P. = BLANK COVER PLATE, METALLIC, GANG SIZE AS DENOTED BY #.	



13803 N. PROMENADE
STAFFORD, TX 77477-5753
PH. 281.566.4100
FX. 281.566.4109

TYPICAL HOSPITAL (NOT PROJECT SPECIFIC)
OR1® NEO SERIES SYSTEM
FACILITY REQUIREMENTS:
LEGENDS, SCHEDULES & RISERS

CONFIDENTIAL - NOT TO BE DISTRIBUTED OUTSIDE OF KSEA, INC.
This drawing is the property of KARL STORZ ENDOSKOPE, and is not to be reproduced or copied in whole or in part. It is only to be used for the project and site specifically. Identified herein and is not to be used on any other project. It is to be returned upon request.

REVISIONS:	DATE:
Δ REV. 0:	3/31/2022
(INITIAL RELEASE)	

DRAWN BY: SSatre	
ENG. BY:	
DATE: 00/00/2022	
FILE NAME: GENERIC_NEO_FACILITY_DRAWINGS.DWG	
PLT SC N.T.S	
Generic_NEO_Facility Drawings	
CHK. BY:	DATE:

JOB NO.	
GENERIC	
DRAWING NUMBER	
AV.IP. 6.1.1	

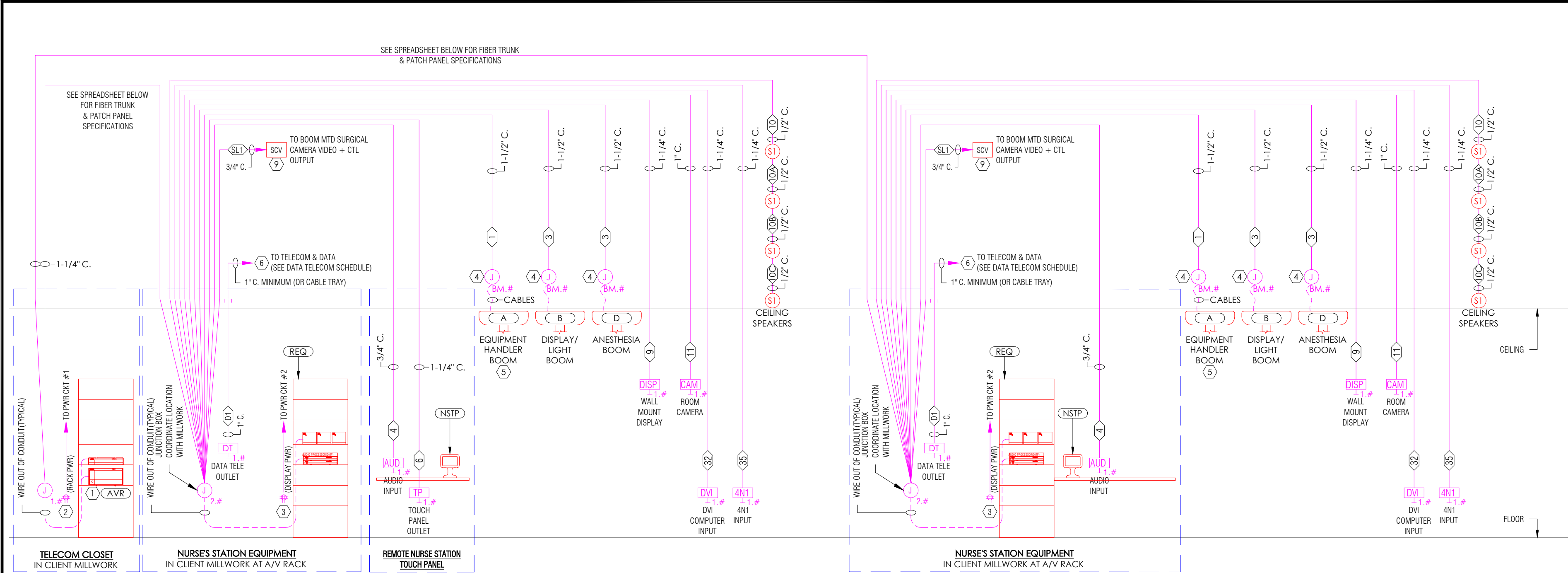

1 A/V SYSTEM CONDUIT RISER - REMOTE SPLIT SYSTEM
SCALE: N.T.S.

NOTE:
1. MAXIMUM 70 FT. CONDUIT LENGTH (100 FT. CABLE LENGTH) ON RUNS FROM RACK TO OR EQUIPMENT WITH OUT FIBER TRUNK.
2. DEDICATED 4 mm² - 6 mm², MAX Ø 5.9 mm GROUND WIRE FROM GROUND PANEL TO A/V RACK PROVIDED BY C.C. (NOT STORZ).
3. A/V EQUIPMENT REQUIRES ADEQUATE AIR EXCHANGE PASSIVE OR ACTIVE FOR **NOMINAL TEMPERATURE OF 90° FAHRENHEIT**.

Fiber Optic Trunk Cable Specification		Fiber Optic Patch Panel Cassette Specification	
Cable Type:	Indoor Trunk	Fiber Count:	24 x 2 (Total 48)
Cable Jacket Rating:	Plenum (OFNP)	Fiber Type:	Multimode OM3 50/125µm or OM4 50/125 µm
Fiber Type:	Multimode OM3 50/125µm or OM4 50/125 µm	Front Connectivity:	LC Duplex
Connector Type End 'A':	MPO (12 Strand) Male	Split Sleeve Material:	Zirconia Ceramic
Connector Type End 'B':	MPO (12 Strand) Male	Rear MTP Connectivity:	Multimode TP Adapter(s) with Male Ferrules (pins) and PC Polish
Cable Polarity:	Method B	Operating Temperature:	0°C to 70°C
Fiber Count:	Varies by System	Insertion Loss (Link Loss):	0.75dB Maximum (Per Channel)
Jacket Color:	Aqua	Return Loss:	>26dB (Per Channel)
Maximum Cable Attenuation:	3.5dB/km at 850nm	Connector Durability:	MTP - 500 Mating Cycles
(Multimode)	1.5dB/km at 1300nm		
Maximum Connector Insertion Loss:	Multimode MPO: 0.50dB		
Maximum Connector Return Loss:	Multimode MPO: 26dB		
Cable Maximum Outside Diameter (OD):	11.1mm		
Minimum Bend Radius:	Under load: 20 x cable OD		
	Static: 10 x cable OD		
Cable Flex:	100 Cycles		
Cable Twist:	10 Cycles		
Connector Durability:	MTP - 500 Mating Cycles		
Transition Outside Diameter (MPO):	48-fiber: 19mm		
	72-fiber: 19mm		
	96-fiber: 19mm		
	144-fiber: 19mm		
Pulling Eye Diameter:	48-fiber: 41mm		
	72-fiber: 41mm		
	96-fiber: 41mm		
	144-fiber: 41mm		
Breakout Length:	1 meter		
Installation Temperature:	0°C to 70°C		
Operating Temperature:	-20°C to 70°C		

NOTES:

- CLIENT'S CONTRACTOR PROVIDES FIBER TRUNK & PATCH PANEL @ BOTH ENDS(NOT STORZ)
- 300m MAX TRUNK LINE DISTANCE

The designs shown on these drawings are planning concept designs only, are not drawn to scale, are not drawn as architectural plans or detailed engineering drawings, do not represent full detail working designs, and do not represent or incorporate detail structural or engineering analysis. These drawings are provided "as-is" and are intended to be used only as planning concept guides, and not for any other purpose. All warranties and representations of any kind, whether expressed, implied or statutory, including warranties of merchantability and fitness for a particular purpose, with regard to the designs or drawings by a recipient in any manner other than as herein intended. Any recipient of these drawings hereby agrees to indemnify Karl Storz against any and all claims, liability, damages and costs (including attorneys' fees) arising out of, or resulting from, any use of these designs or drawings other than as herein intended.



13803 N. PROMENADE
STAFFORD, TX 77477-5753
PH. 281.566.4100
FX. 281.566.4109

TYPICAL HOSPITAL (NOT PROJECT SPECIFIC)
OR1® NEO SERIES SYSTEM
FACILITY REQUIREMENTS:
LEGENDS, SCHEDULES & RISERS

CONFIDENTIAL - NOT TO BE DISTRIBUTED OUTSIDE OF KSEA, INC.
This drawing is the property of KARL STORZ ENDOSKOPE, and is not to be reproduced or copied in whole or in part. It is only to be used for the project and site specifically identified herein and is not to be used on any other project. It is to be returned upon request.

REVISIONS:	DATE:
Δ REV. 0:	3/31/2022
(INITIAL RELEASE)	

DRAWN BY:	SSatre
ENG. BY:	
DATE:	00/00/2022
FILE NAME:	GENERIC_NEO_FACILITY_DRAWINGS.DWG
PLT SC	N.T.S
Generic_NEO_Facility_Drawings	

CHK. BY:	DATE:

JOB NO.
GENERIC

DRAWING NUMBER
**AV.IP.
6.1.2**

03 OF 12

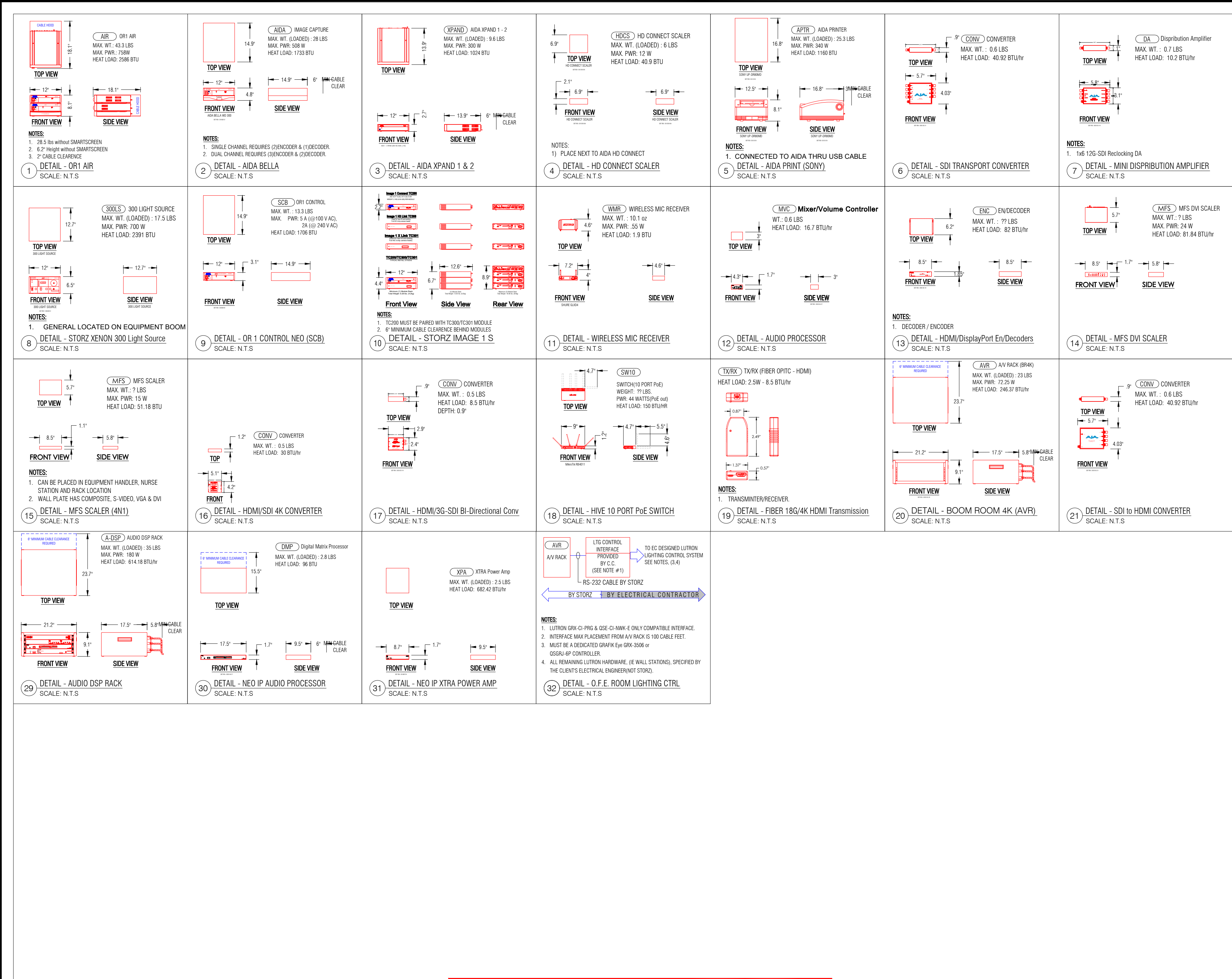

The designs shown on these drawings are planning concept designs only, are not drawn to scale, are not drawn as architectural plans or detailed engineering drawings, do not represent full detail working designs, and do not represent or incorporate detail structural or engineering analysis. These drawings are provided "as-is" and are intended to be used only as planning concept guides, and not for any other purpose. All warranties and representations of any kind, whether expressed, implied or statutory, including warranties of merchantability and fitness for a particular purpose, with regard to the designs or drawings by a recipient in any manner other than as herein intended. Any recipient of these drawings hereby agrees to indemnify Karl Storz against any and all claims, liability, damages and costs (including attorneys' fees) arising out of, or resulting from, any use of these designs or drawings other than as herein intended.

WARNING:
A/V EQUIPMENT REQUIRES ADEQUATE AIR EXCHANGE PASSIVE OR ACTIVE FOR NOMINAL TEMPERATURE OF 90° FAHRENHEIT.



13803 N. PROMENADE
STAFFORD, TX 77477-5753
PH. 281.566.4100
FX. 281.566.4109

FOR COORDINATION ONLY - NOT FOR CONSTRUCTION

TYPICAL HOSPITAL (NOT PROJECT SPECIFIC)

OR1® NEO SERIES SYSTEM

FACILITY REQUIREMENTS:

REQUIREMENTS DETAILS #2

CONFIDENTIAL - NOT TO BE DISTRIBUTED OUTSIDE OF KSEA, INC.
This drawing is the property of KARL STORZ ENDOSCOPE, and is not to be reproduced or copied in whole or in part. It is only to be used for the project and site specifically identified herein and is not to be used on any other project. It is to be returned upon request.

REVISIONS:	DATE:
Δ REV. 0:	3/31/2022
(INITIAL RELEASE)	

DRAWN BY: SSatre
ENG. BY:
DATE: 00/00/2022
FILE NAME: GENERIC_NEO_FACILITY_DRAWINGS.DWG
PLT SC N.T.S
Generic_NEO_Facility_Drawings

CHK. BY:	DATE:

JOB NO.
GENERIC

DRAWING NUMBER
**AV.IP.
6.2.2**

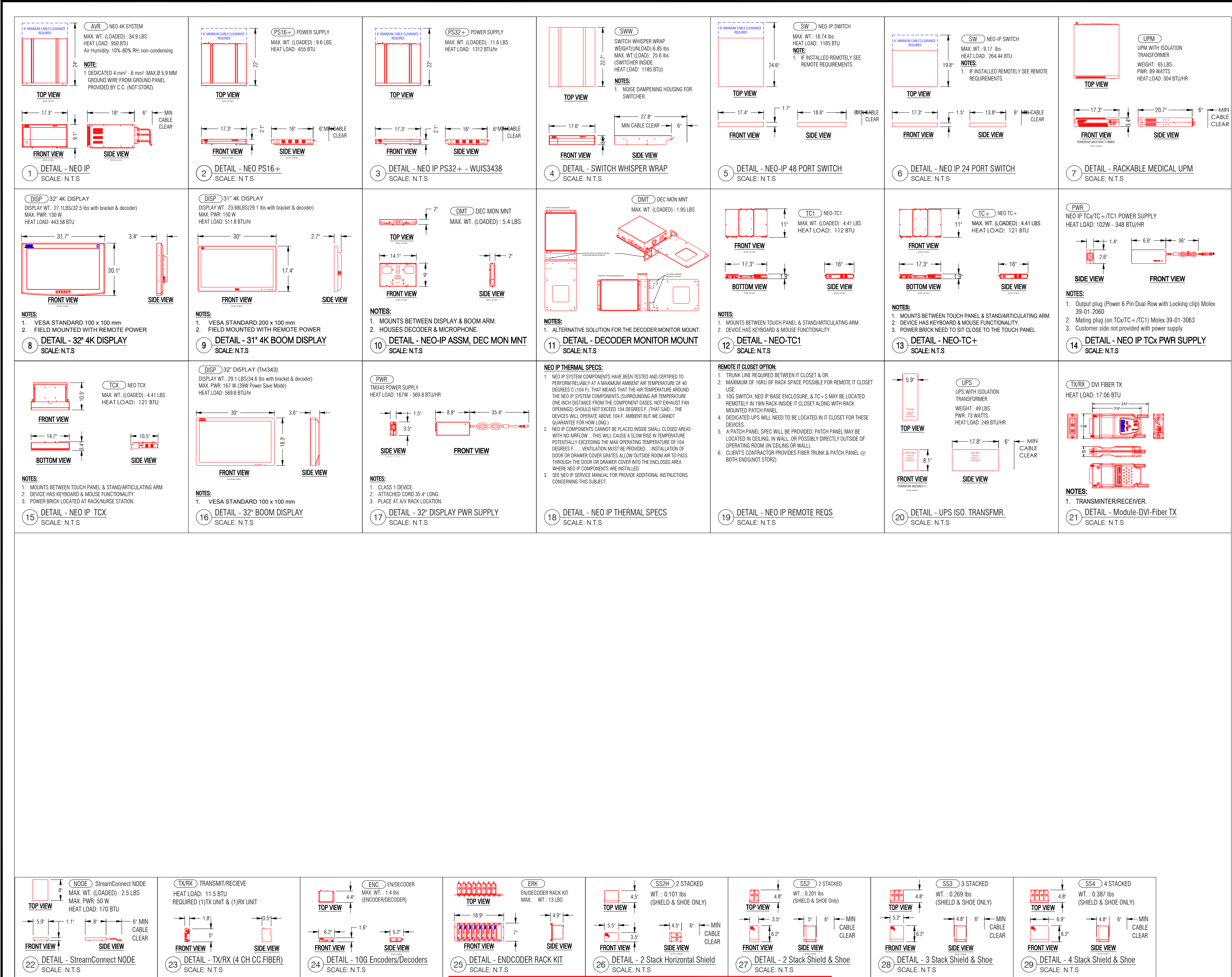

The designs shown on these drawings are planning concept designs only, are not drawn to scale, are not drawn as architectural plans or detailed engineering drawings, do not represent full detail working designs, and do not represent or incorporate detail structural or engineering analysis. These drawings are provided "as-is" and are intended to be used only as planning concept guides, and not for any other purpose. All warranties and representations of any kind, whether expressed, implied or statutory, including warranties of merchantability and fitness for a particular purpose, with regard to the designs or drawings by a recipient in any manner other than as herein intended. Any recipient of these drawings hereby agrees to indemnify Karl Storz against any and all claims, liability, damages and costs (including attorneys' fees) arising out of, or resulting from, any use of these designs or drawings other than as herein intended.

WARNING:
A/V EQUIPMENT REQUIRES ADEQUATE AIR EXCHANGE PASSIVE OR ACTIVE FOR NOMINAL TEMPERATURE OF 90° FAHRENHEIT.

FOR COORDINATION ONLY - NOT FOR CONSTRUCTION



13803 N. PROMENADE
STAFFORD, TX 77477-5753
PH. 281.566.4100
FX. 281.566.4109

TYPICAL HOSPITAL (NOT PROJECT SPECIFIC)
OR1@ NEO SERIES SYSTEM
FACILITY REQUIREMENTS:
REQUIREMENTS DETAILS #3(NEO-IP)
CONFIDENTIAL - NOT TO BE DISTRIBUTED OUTSIDE OF KSEA, INC.
This drawing is the property of KARL STORZ ENDOSKOPE, and is not to be reproduced or copied in whole or in part. It is only to be used for the project and site specifically identified herein and is not to be used on any other project. It is to be returned upon request.

REVISIONS:	DATE:
Δ REV. 0:	3/31/2022
(INITIAL RELEASE)	

DRAWN BY: SSatre
ENG. BY:
DATE: 00/00/2022
FILE NAME: GENERIC_NEO_FACILITY_DRAWINGS.DWG
PLT SC: N.T.S
Generic_NEO_Facility Drawings

CHK. BY:	DATE:
----------	-------

JOB NO.
GENERIC

DRAWING NUMBER
**AV.IP.
6.2.3**

06 OF 12

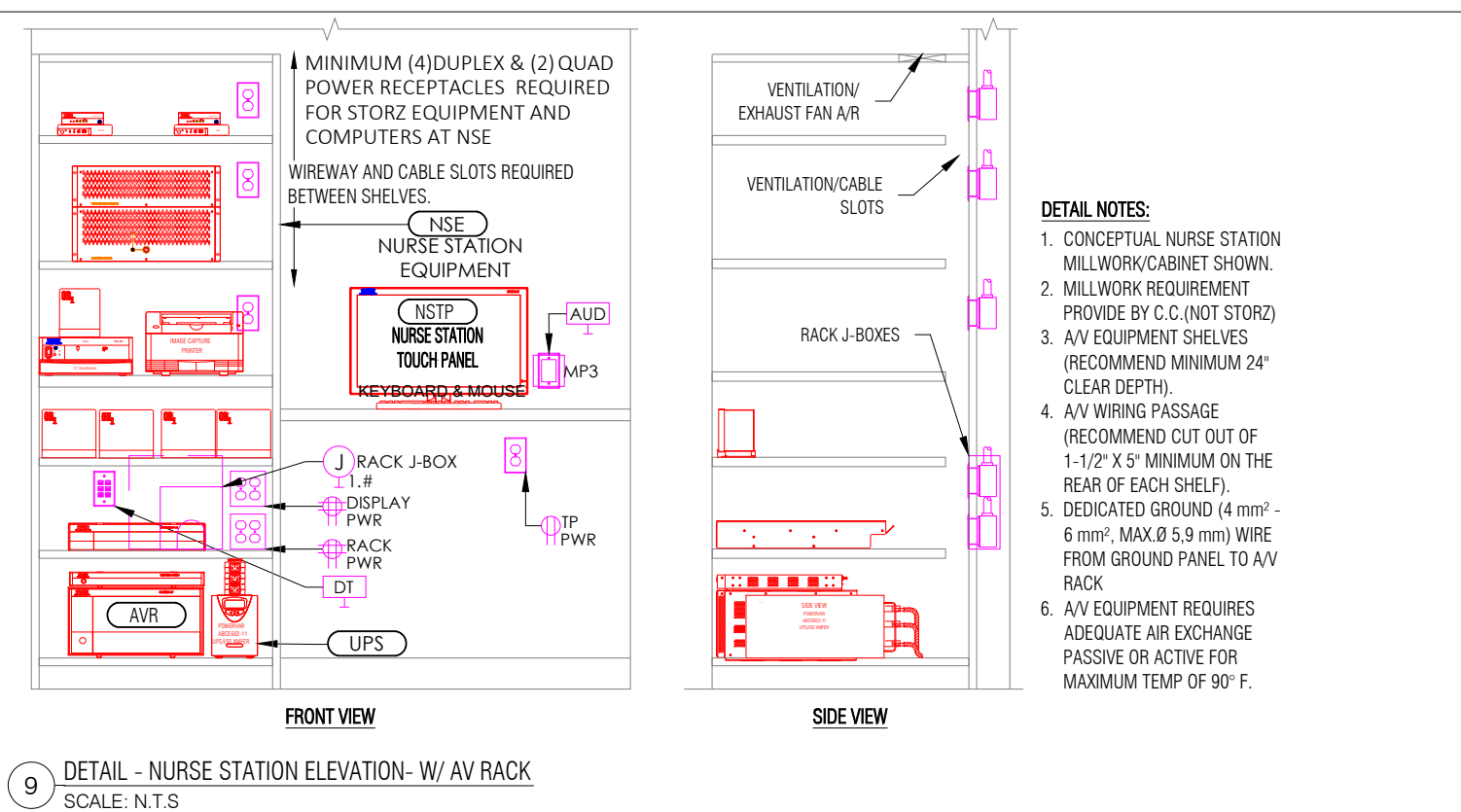
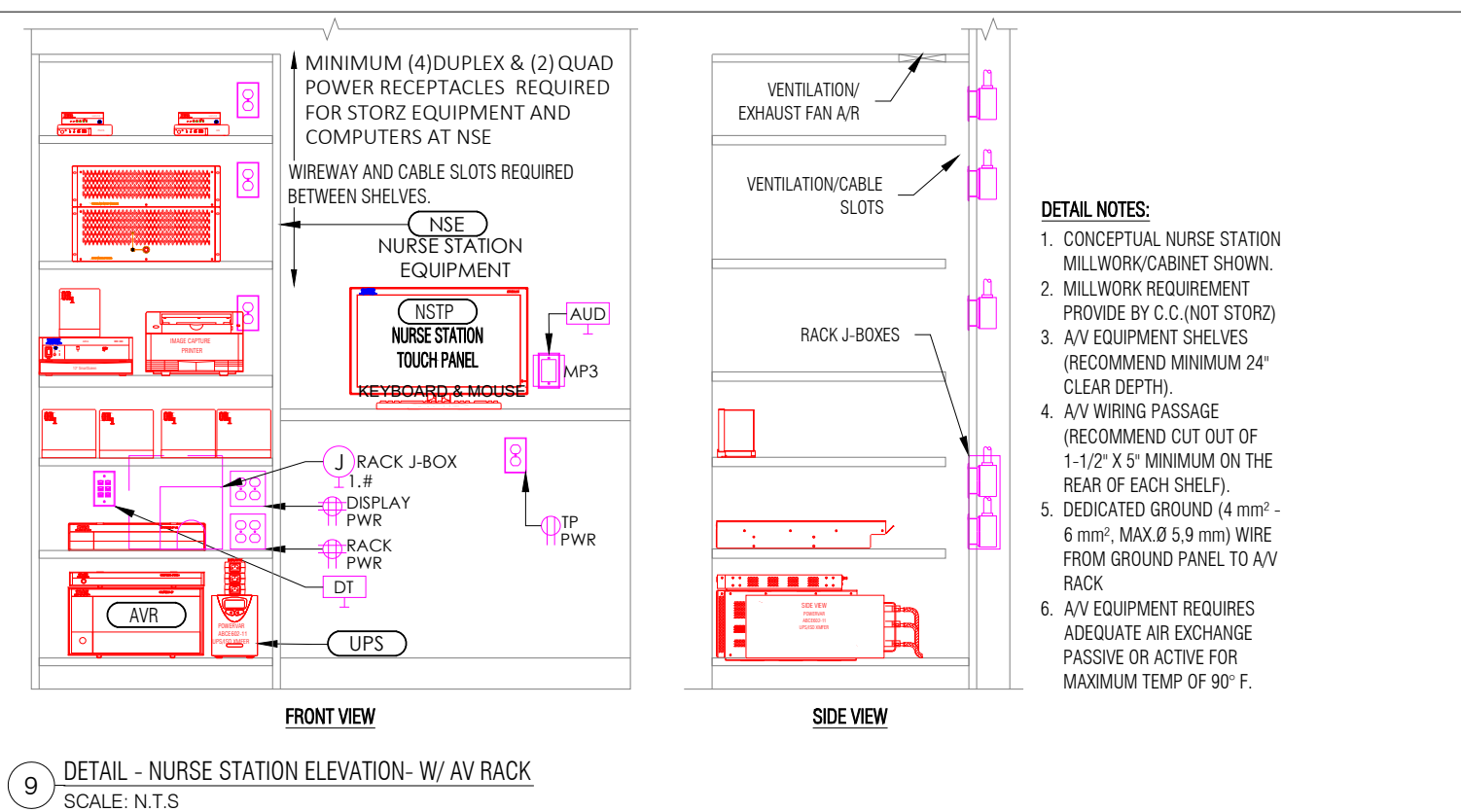
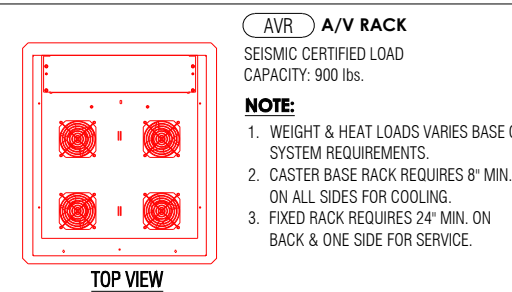
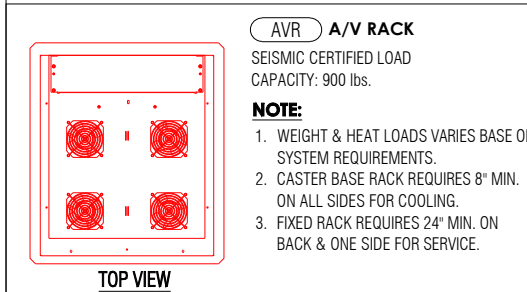
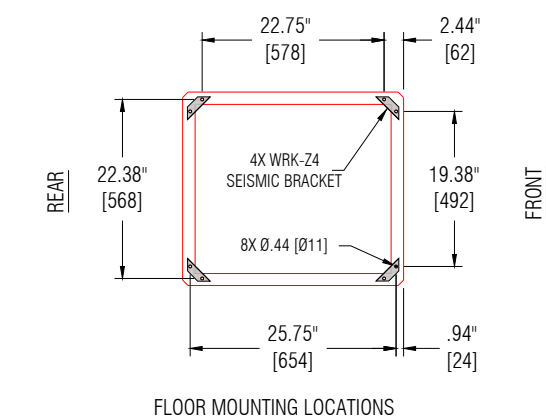
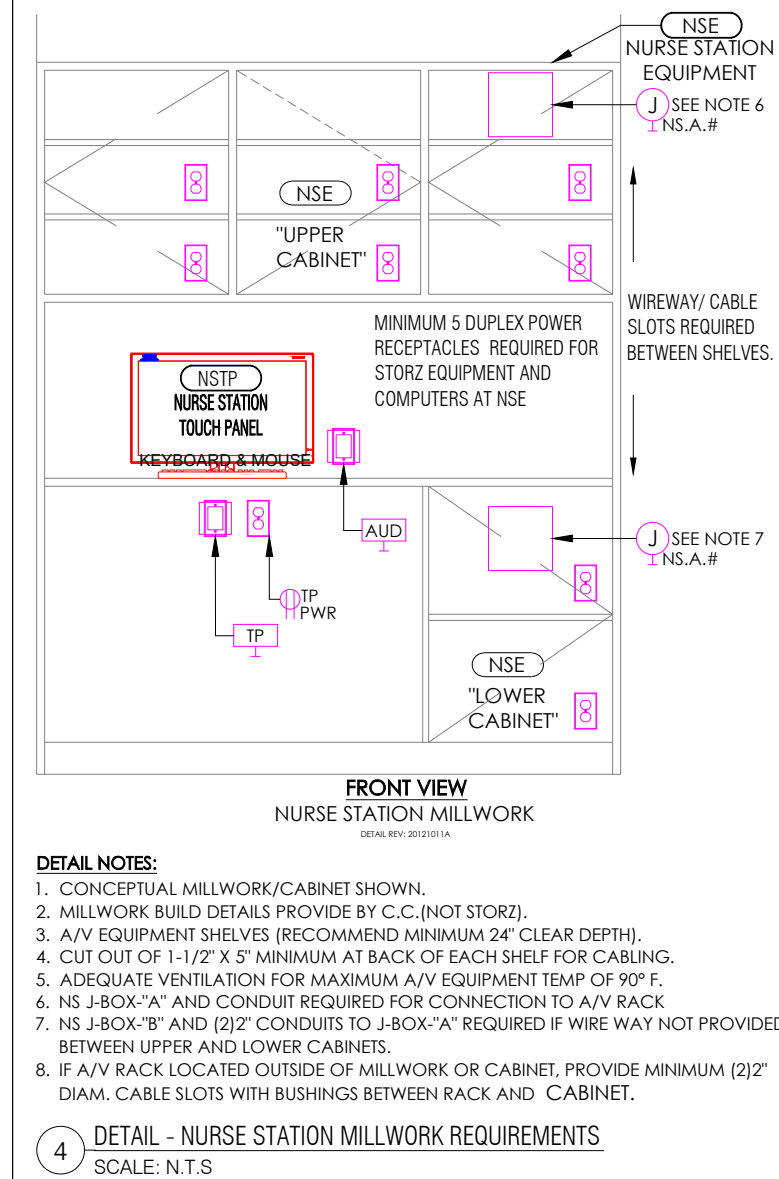
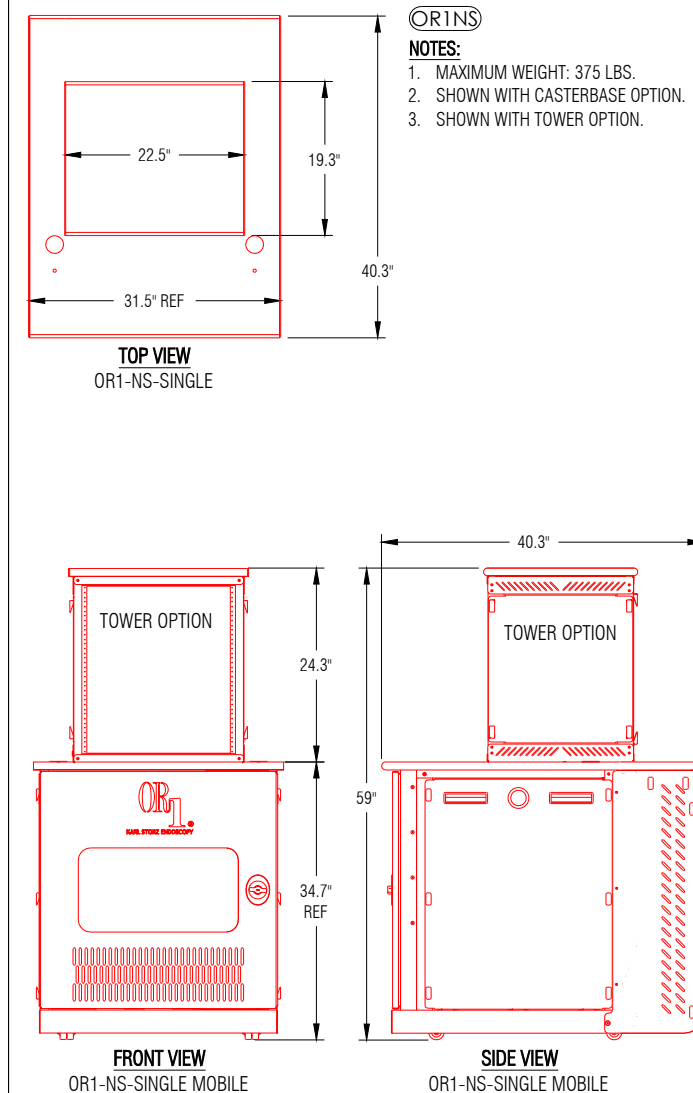
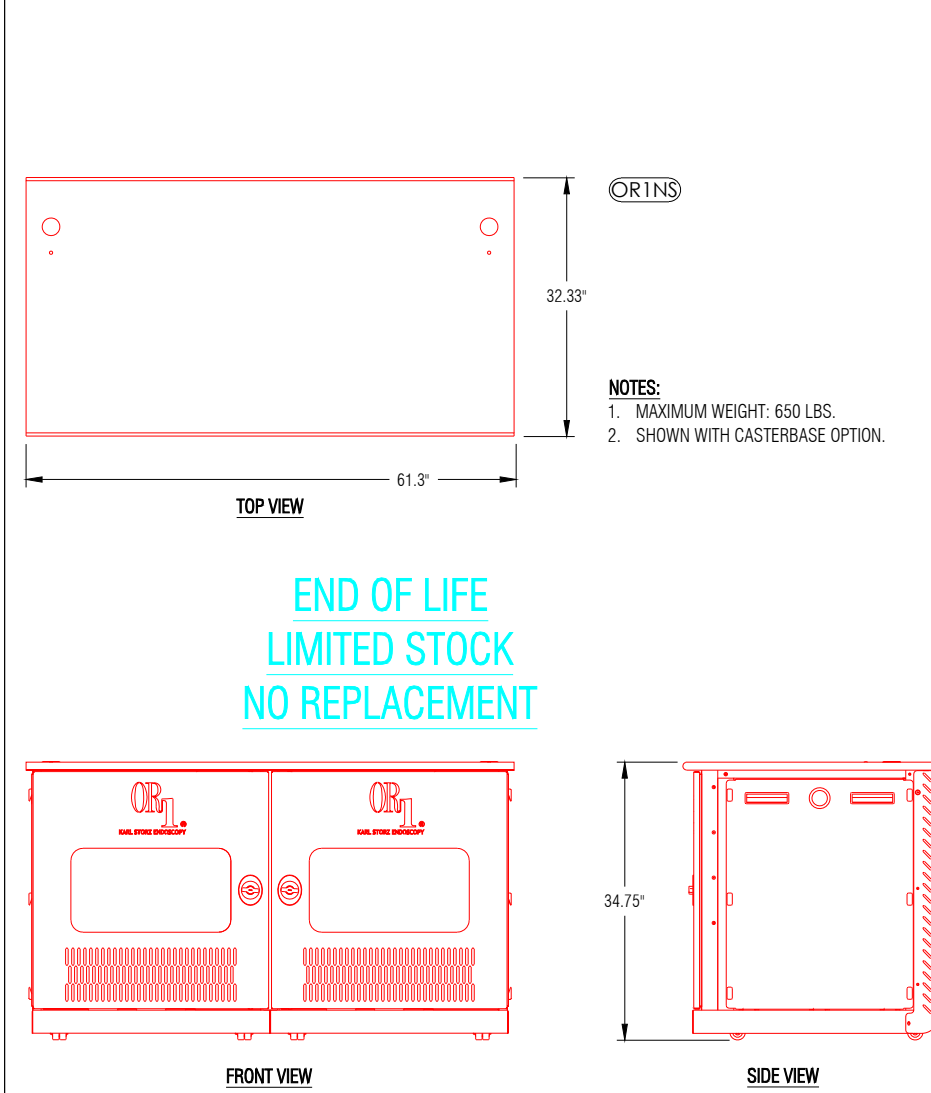
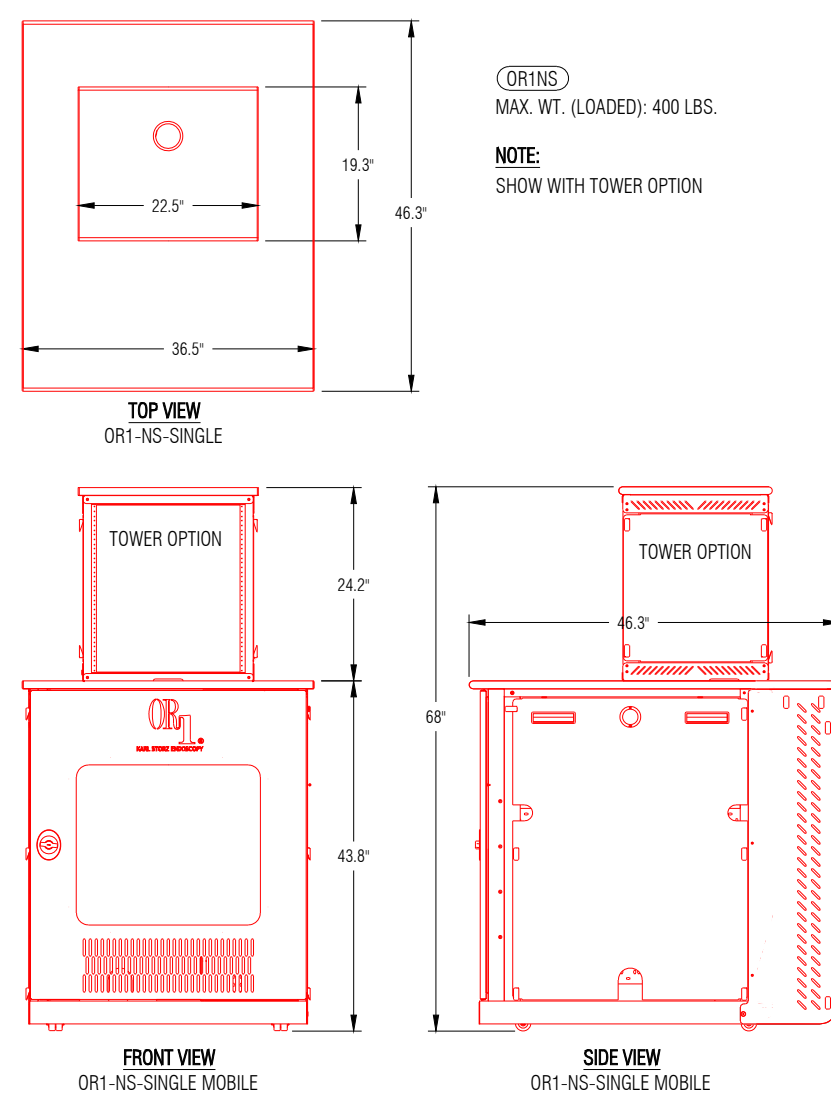

The designs shown on these drawings are planning concept designs only, are not drawn to scale, are not drawn as architectural plans or detailed engineering drawings, do not represent full detailed working drawings, and do not represent or incorporate detailed structural or engineering analysis. These drawings are provided "as-is" and are intended to be used only as planning concept guides, and not for any other purpose. All warranties and representations of any kind, whether expressed, implied or statutory, including warranties of merchantability and fitness for a particular purpose, with regard to the designs or drawings by a recipient in any manner other than as herein intended. Any recipient of these drawings hereby agrees to indemnify, defend and hold harmless the provider of these drawings from and against all claims for damages, losses or expenses of any kind or nature, whether known or unknown, anticipated or unanticipated, arising out of or from the use of these designs or drawings other than as herein intended.

WARNING:
A/V EQUIPMENT REQUIRES ADEQUATE AIR EXCHANGE PASSIVE
OR ACTIVE FOR NOMINAL TEMPERATURE OF 90° FAHRENHEIT.

TYPICAL HOSPITAL (NOT PROJECT SPECIFIC)

OR1® NEO SERIES SYSTEM

FACILITY REQUIREMENTS:

REQUIREMENTS DETAILS #6 (Collaborator1)

CONFIDENTIAL - NOT TO BE DISTRIBUTED OUTSIDE OF KSEA, INC.
This drawing is the property of KARL STORZ ENDOSCOPE, and is not to be reproduced or copied in whole or in part. It is only to be used for the project and site specifically. Identified herein and is not to be used on any other project. It is to be returned upon request.

FOR COORDINATION ONLY - NOT FOR CONSTRUCTION

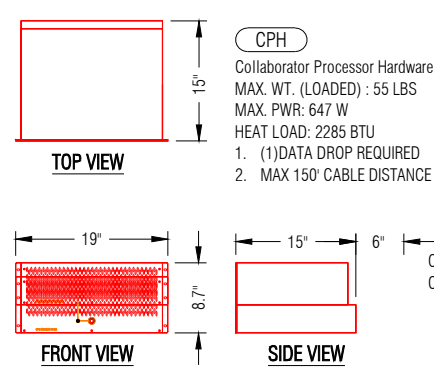

1 DETAIL - Collaborator Processor Hardware
SCALE: N.T.S

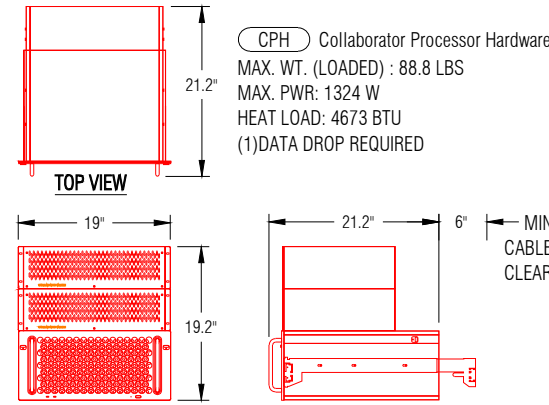

2 DETAIL - Collaborator Processor Hardware
SCALE: N.T.S

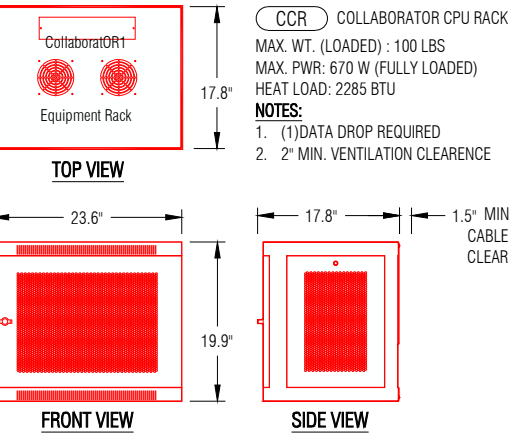

3 DETAIL - Collaborator CPU Rack (9RU)
SCALE: N.T.S

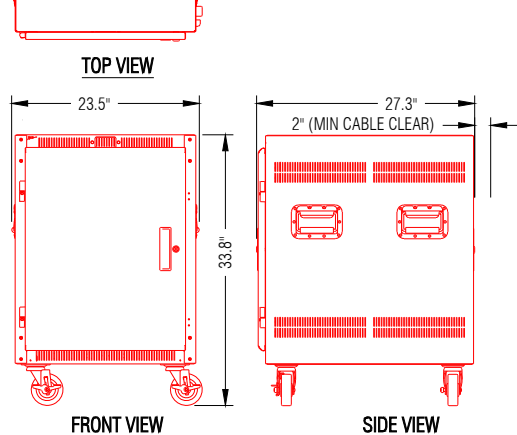

4 DETAIL - Collaborator CPU Rack (Processor Pro)
SCALE: N.T.S

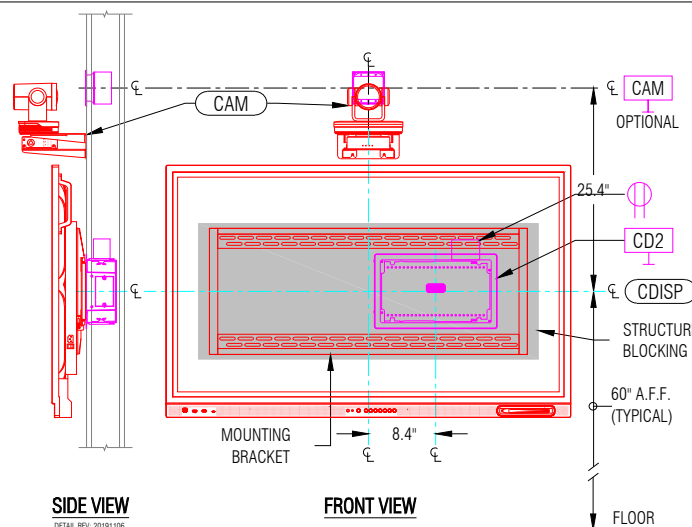

MODEL	DIMENSION	WEIGHT	POWER
T1V 55"	50.63" W x 31.55" H x 3.1" D	128lbs	625W

5 DETAIL - 55" COLLABORATOR WALL DISPLAY
SCALE: N.T.S

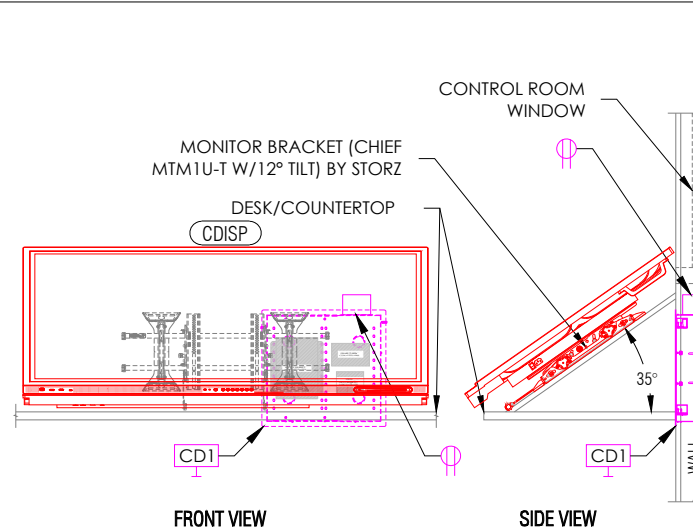

MODEL	DIMENSION	WEIGHT	POWER
T1V 55"	50.63" W x 31.55" H x 3.1" D	128lbs	625W

25 DETAIL - 55" COLLABORATOR WALL DISPLAY
SCALE: N.T.S

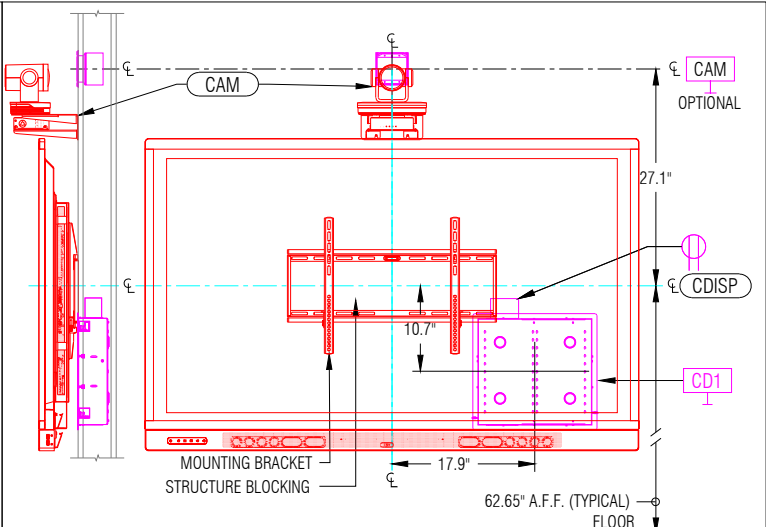

MODEL	DIMENSION	WEIGHT	POWER
T1V 55"	50.63" W x 31.55" H x 3.1" D	128lbs	625W

7 DETAIL - WALL MOUNTED LCD DISPLAY
SCALE: N.T.S

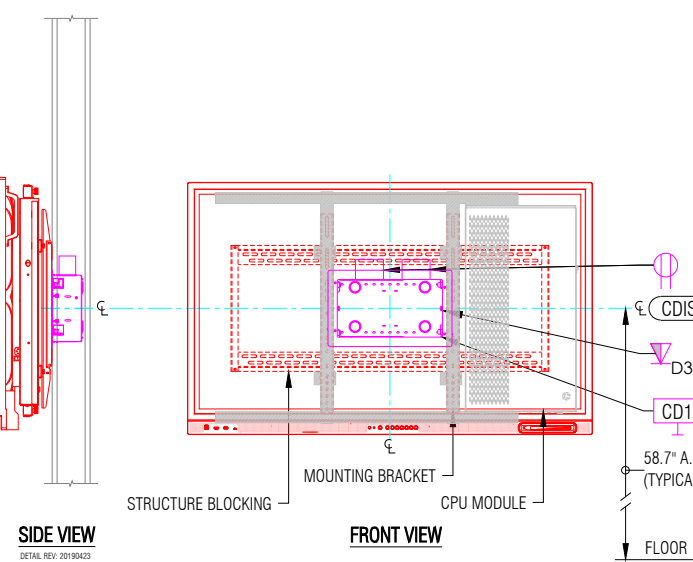

MODEL	DIMENSION	WEIGHT	POWER
T1V 55"	50.63" W x 31.55" H x 3.1" D	158lbs	695 BTU/hr

8 DETAIL - 55" COLLABORATOR LITE DISPLAY/CPU
SCALE: N.T.S

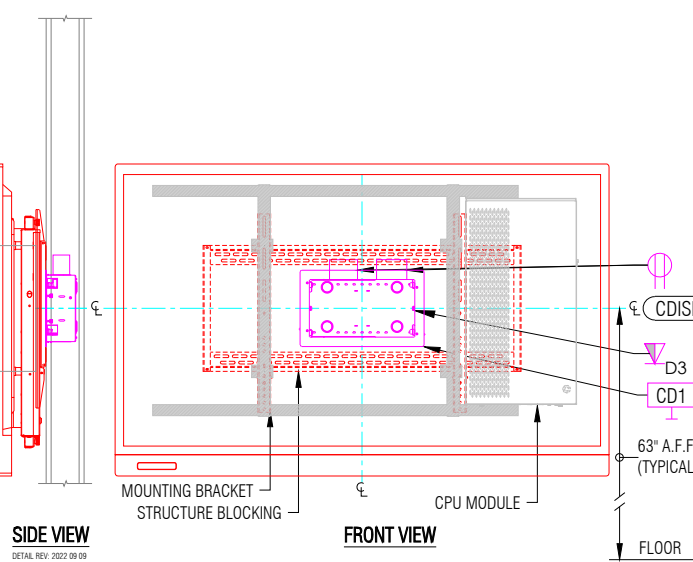

MODEL	DIMENSION	WEIGHT	POWER
T1V 65"	61.7" W x 39" H x 5.5" D	150lbs	682 BTU/hr

9 DETAIL - 65" COLLABORATOR LITE DISPLAY/CPU
SCALE: N.T.S

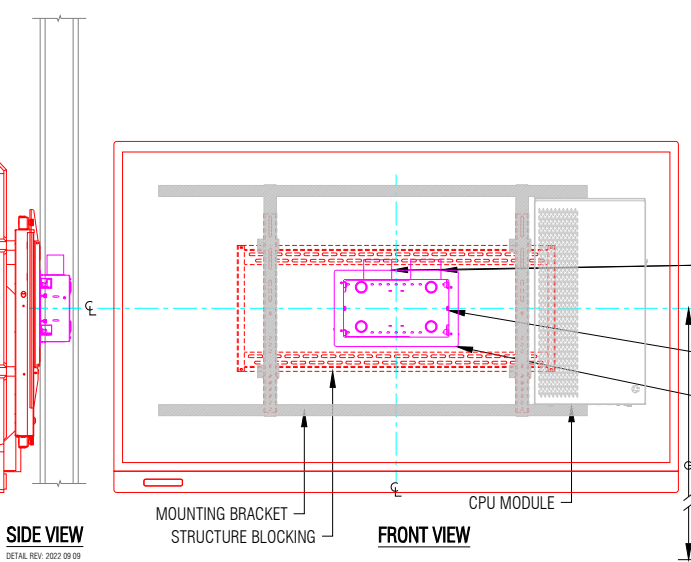

MODEL	DIMENSION	WEIGHT	POWER
T1V 65"	61.7" W x 39" H x 5.5" D	150lbs	682 BTU/hr

10 DETAIL - 65" COLLABORATOR LITE DISPLAY/CPU
SCALE: N.T.S

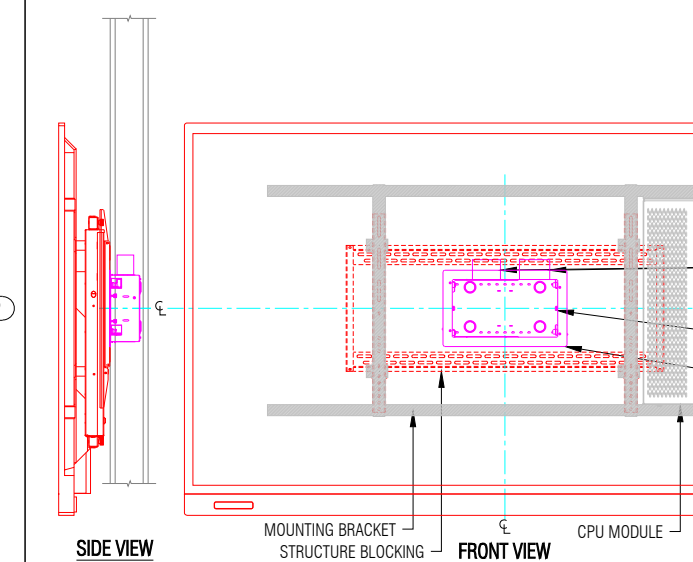

MODEL	DIMENSION	WEIGHT	POWER
T1V 65"	61.7" W x 39" H x 5.5" D	150lbs	682 BTU/hr

11 DETAIL - 65" COLLABORATOR LITE DISPLAY/CPU
SCALE: N.T.S

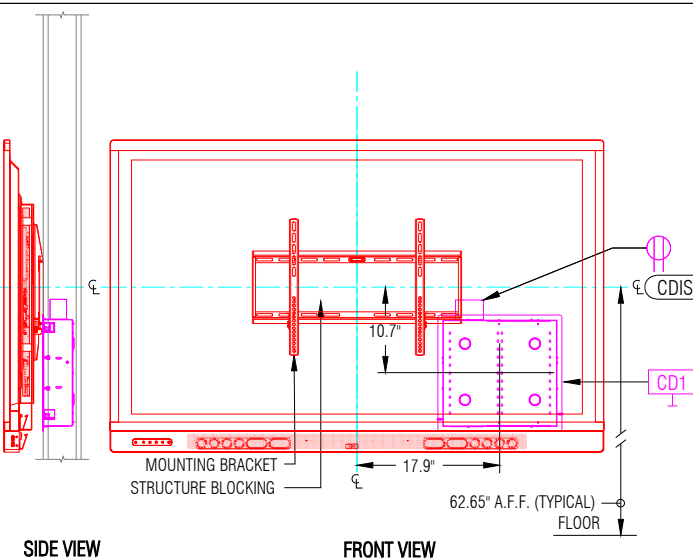

MODEL	DIMENSION	WEIGHT	POWER
T1V 65"	61.7" W x 44" H x 5.8" D	146lbs	1024 BTU/hr

13 DETAIL - 65" COLLABORATOR WALL DISPLAY
SCALE: N.T.S

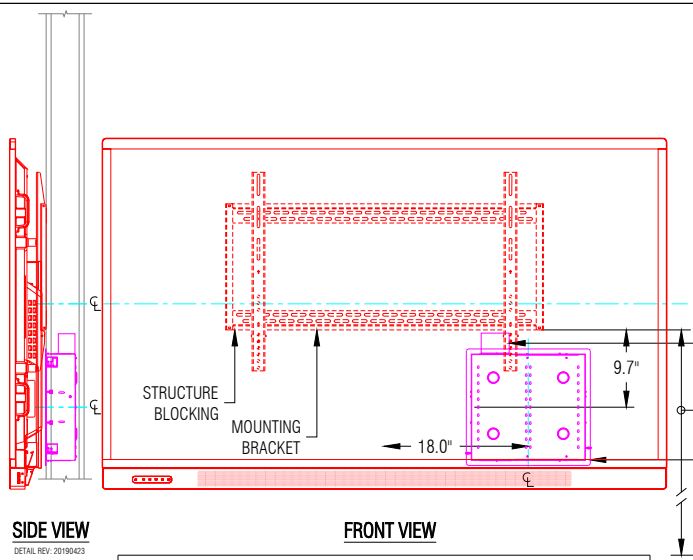

MODEL	DIMENSION	WEIGHT	POWER
T1V 75"	70.5" W x 43.8" H x 4.05" D	140lb	340W

13 DETAIL - 75" COLLABORATOR WALL DISPLAY
SCALE: N.T.S

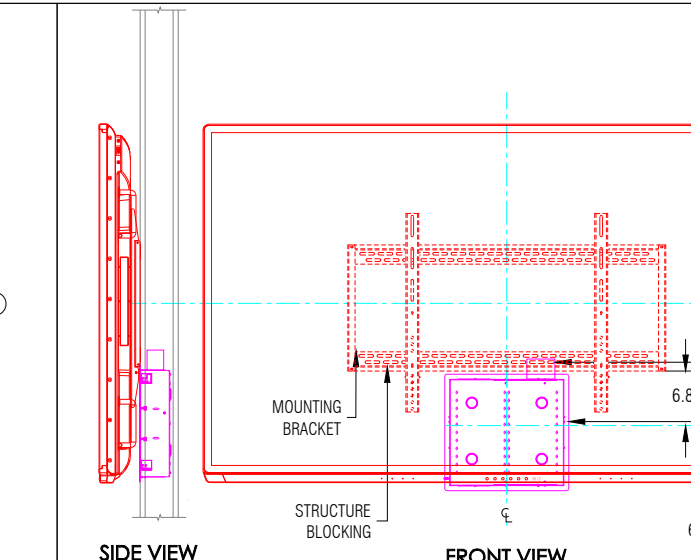

MODEL	DIMENSION	WEIGHT	POWER
T1V 75"	70.5" W x 43.8" H x 4.05" D	140lb	340W

14 DETAIL - 75" COLLABORATOR WALL DISPLAY
SCALE: N.T.S

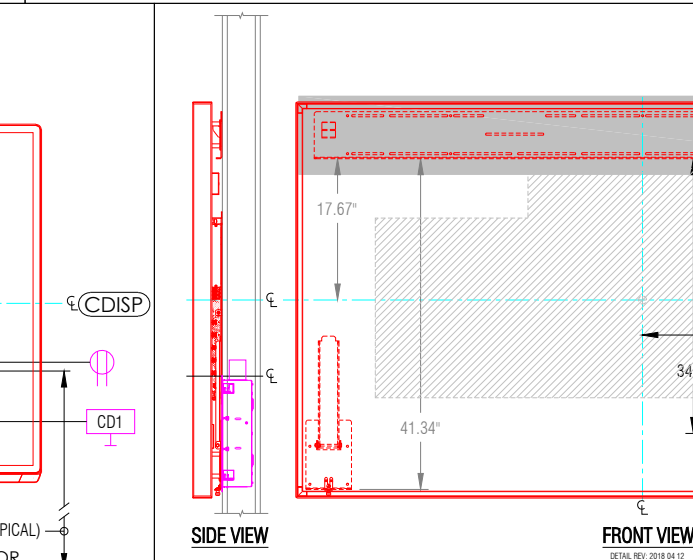

MODEL	DIMENSION	WEIGHT	POWER
T1V 98"	86.7" W x 49.5" H x 3.6" D	330 LBS.	410W

15 DETAIL - 98" COLLABORATOR WALL MOUNTED LCD DISPLAY
SCALE: N.T.S

WARNING:

A/V EQUIPMENT REQUIRES ADEQUATE AIR EXCHANGE PASSIVE OR ACTIVE FOR NOMINAL TEMPERATURE OF 90° FAHRENHEIT.

The designs shown on these drawings are planning concept designs only, are not drawn to scale, are not drawn as architectural plans or detailed engineering drawings, do not represent full detail working drawings, and do not represent or incorporate detail structural or engineering analysis. These drawings are provided "as-is" and are intended to be used only as planning concept guides, and not for any other purpose. All warranties and representations of any kind, whether expressed, implied or statutory, including warranties of merchantability and fitness for a particular purpose, with regard to the designs or drawings by a recipient in any manner other than as herein intended. Any recipient of these drawings hereby agrees to indemnify Karl Storz against any and all claims, liability, damages and costs (including attorneys' fees) arising out of, or resulting from, any use of these designs or drawings other than as herein intended.

The designs shown on these drawings are planning concepts design only, are not drawn to scale, are not intended to be used as a basis for construction, and do not represent a contract. These drawings are provided for informational purposes only and are not intended to be used as a basis for construction. All dimensions and quantities are approximate and are subject to change without notice. The drawings are provided for informational purposes only and are not intended to be used as a basis for construction. All dimensions and quantities are approximate and are subject to change without notice. The drawings are provided for informational purposes only and are not intended to be used as a basis for construction. All dimensions and quantities are approximate and are subject to change without notice.

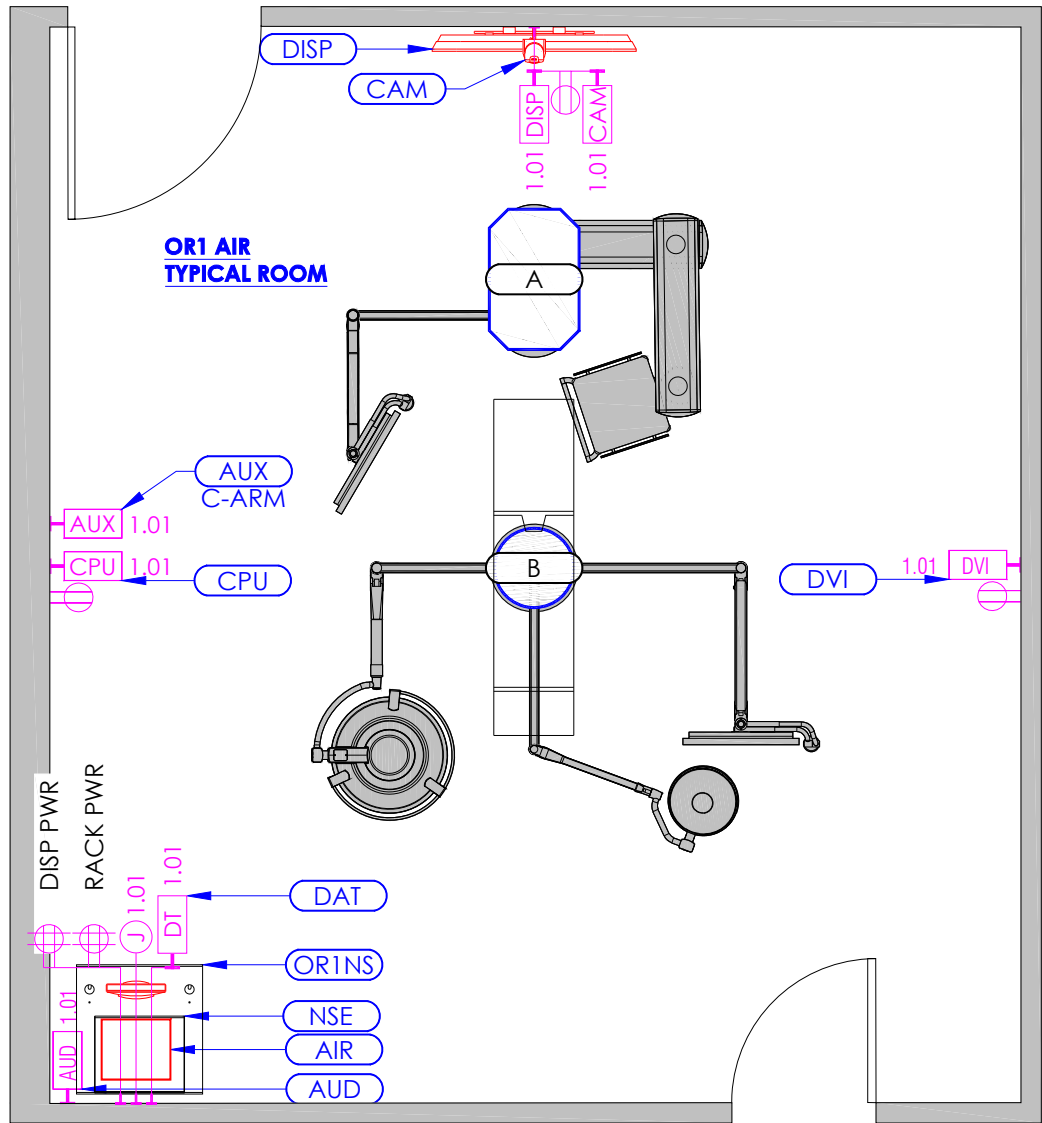

1 FLOOR PLAN - OR1 AIR TYPICAL ROOM
SCALE: N.T.S
BACKGROUND REF.: *.DWG RECEIVED xx/xx/xxxx

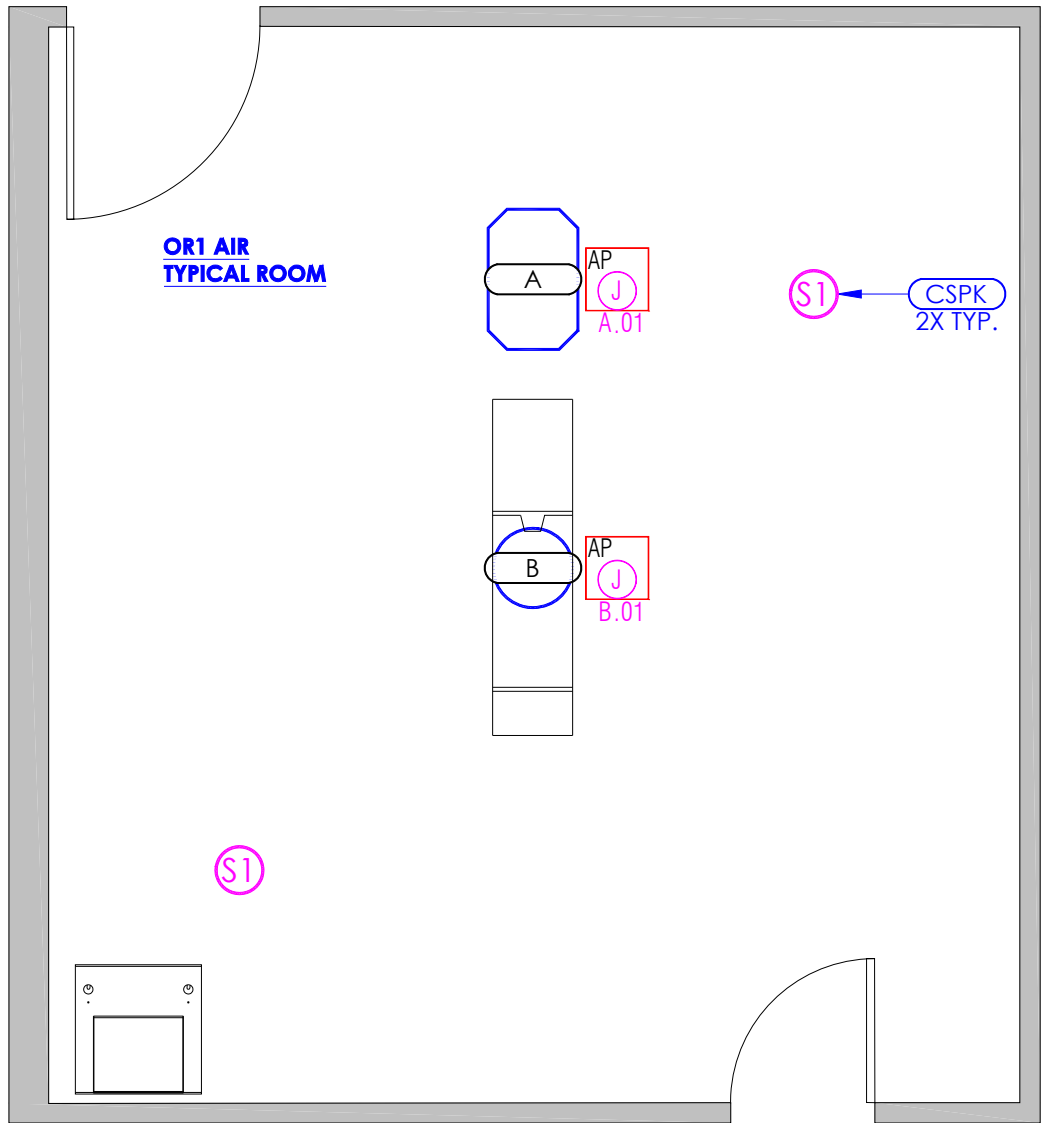

2 REFLECTED CEILING PLAN - OR1 AIR TYPICAL ROOM
SCALE: N.T.S
BACKGROUND REF.: *.DWG RECEIVED xx/xx/xxxx

AV EQUIPMENT SCHEDULE			
SYMBOL	LOCATION/DEVICE	EQUIPMENT BY STORZ	EQUIPMENT BY OTHERS
A	EQUIPMENT BOOM (STORZ EQUIPMENT)	(1) STORZ CCU INPUT PLATE, (1) AUX INPUT (DVI/VGA/SV/CV) PLATE, (1) 32" FLAT PANEL DISPLAY	DISPLAY MOUNT
B	DISPLAY/LIGHT BOOM	(1) 32" FLAT PANEL DISPLAY	DISPLAY MOUNT/SURGICAL LIGHT
ORINS	OR1 NURSE STATION CABINET	(1) SINGLE MOBILE NS CABINET	
AIR	4K VIDEO PROCESSOR	(1) 4K VIDEO PROCESSOR, (1) AIDA (BELLA) with 12" SmartScreen, FLAT PANEL DISPLAY POWER SUPPLIES	
NSE	NURSE'S STATION EQUIPMENT CABINET	(1) MEDICAL PRINTER (1) MINI CONVERTER, (1) LOCAL COMPUTER INPUT, (1) IN-LIGHT CCU INPUT	PACS COMPUTER, IN-LIGHT CCU
AUD	WALL MOUNTED	(1) MP3 AUDIO INPUT	
AUX	WALL MOUNTED	(1) AUX (DVI/VGA/SV/CV) INPUT	
CAM	WALL MOUNTED	(1) PTZ CAMERA	STRUCTURE FOR MOUNTING
CPU	WALL MOUNTED	(1) REMOTE (HDMI)COMPUTER INPUT	
CSPK	CEILING MOUNTED	(2) CEILING SPEAKER ASSEMBLY, (1) CEILING SPEAKER HOLE TEMPLATE	HOLE CUT IN SHEETROCK BY C.C.(NOT STORZ). CUTOUT TEMPLATE PROVIDED BY STORZ.
DAT	WALL MOUNTED	(FOR DATA TELECOM CONNECTION)	SEE DATA / TELECOM SCHEDULE
DISP	WALL MOUNTED	(1) LARGE FORMAT FLAT PANEL DISPLAY	BRACKET ANCHORAGE BY C.C. (NOT STORZ)
DVI	WALL MOUNTED	(1) DVI INPUT PLATE	
AV EQUIPMENT SCHEDULE NOTES: 1. EQUIPMENT LISTED IS FOR COORDINATION PURPOSES ONLY. (BASED ON STORZ'S UNDERSTANDING OF EQUIPMENT & LOCATIONS). REFER TO CONTRACT SPECIFICATIONS FOR ACTUAL REQUIREMENTS.			

FOR COORDINATION ONLY - NOT FOR CONSTRUCTION



13803 N. PROMENADE
STAFFORD, TX 77477-5753
PH. 281.566.4100
FX. 281.566.4109

TYPICAL HOSPITAL (NOT PROJECT SPECIFIC)
OR1® NEO SERIES SYSTEM
FACILITY REQUIREMENTS:
FLOOR PLAN & RCP - OR1 AIR TYPICAL ROOM
CONFIDENTIAL - NOT TO BE DISTRIBUTED OUTSIDE OF KSEA, INC.
This drawing is the property of KARL STORZ ENDOSKOPE, and is not to be reproduced or copied in whole or in part. It is only to be used for the project and site specifically. Identified herein and is not to be used on any other project. It is to be returned upon request.

REVISIONS:	DATE:
Δ REV. 0:	3/31/2022
(INITIAL RELEASE)	
DRAWN BY: SSatre	
ENG. BY:	
DATE: 00/00/2022	
FILE NAME: GENERIC_NEO_FACILITY_DRAWINGS.DWG	
PLT SC N.T.S	
Generic_NEO_Facility Drawings	
CHK. BY:	DATE:
JOB NO.	
GENERIC	
DRAWING NUMBER	
AV.IP. 6.4.01	
10 OF 12	

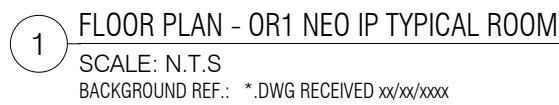

AV EQUIPMENT SCHEDULE NOTES:
1. EQUIPMENT LISTED IS FOR COORDINATION PURPOSES ONLY. (BASED ON STORZ'S UNDERSTANDING OF EQUIPMENT & LOCATIONS). REFER TO CONTRACT SPECIFICATIONS FOR ACTUAL REQUIREMENTS.

AV EQUIPMENT SCHEDULE NOTES:
1. EQUIPMENT LISTED IS FOR COORDINATION PURPOSES ONLY. (BASED ON STORZ'S UNDERSTANDING OF EQUIPMENT & LOCATIONS). REFER TO CONTRACT SPECIFICATIONS FOR ACTUAL REQUIREMENTS.

FOR COORDINATION ONLY - NOT FOR CONSTRUCTION

**- HOSPITAL (NOT PROJECT SPECIFIC)
OR1® NEO SERIES SYSTEM**

FACILITY REQUIREMENTS:

FLOOR PLAN & RCP - OR1 NEO IP TYP. RM

CONFIDENTIAL - NOT TO BE DISTRIBUTED OUTSIDE OF KSEA, INC.

This drawing is the property of KARL STORZ ENDOSCOPY, and is not to be reproduced or copied in whole or in part. It is only to be used for the project and site specifically. Identified herein and is not to be used on any other project. It is to be returned upon request.

DRAWN BY:	SSatre
ENG. BY:	
DATE:	00/00/2022
FILE NAME:	GENERIC_NEO_FACILITY_DRAWINGS.DWG
PLT SC	N.T.S
Generic_NEO_Facility_Drawings	

JOB NO.
GENERIC

DRAWING NUMBER
**AV.IP.
6.4.02**

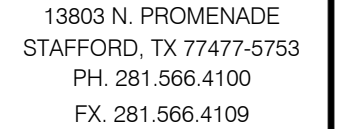

13803 N. PROMENADE
STAFFORD, TX 77477-5753
PH. 281.566.4100
FX. 281.566.4109

TYPICAL HOSPITAL (NOT PROJECT SPECIFIC)

OR1® NEO SERIES SYSTEM
FACILITY REQUIREMENTS:

FACILITY REQUIREMENTS: KISIS PROJECT MANAGEMENT REQUIREMENTS

CONFIDENTIAL - NOT TO BE DISTRIBUTED OUTSIDE OF KSEA, INC.
This drawing is the property of KARL STORZ ENDOSCOPY, and is not to be reproduced or copied in whole or in part. It is only to be used for the project and site specifically. Identified herein and is not to be used on any other project. It is to be returned upon request.

REVISIONS:	DATE:
0 REV. 0:	3/31/2022
(INITIAL RELEASE)	

DRAWN BY:	SSatre
ENG. BY:	
DATE:	00/00/2022
FILE NAME:	GENERIC_NEO_FACILITY_DRAWINGS.DWG
PLT SC	N.T.S
Generic_NEO_Facility_Drawings	

CHK. BY:	DATE:
----------	-------

JOB NO.

GENERIC

DRAWING NUMBER
AV.IP.
6.5.01

12 OF 12

KARL STORZ SITE READINESS CHECKLIST

OVERALL SITE STATE:

Upon KARL STORZ'S arrival at the facility, the site must be clean with all site prep work completed, the boom equipment installed, and the nurse station millwork complete. All owner furnished equipment must be available for installation and testing.

Although other trades may work in the same space, priority must be given to the floor space requirements of staging equipment and materials and the ability of the crew to maintain their workflow.

GENERAL SITE PREP WORK:

- ☐ All required conduits must be marked and installed with pull strings.
- ☐ All facility provided network cables must be installed and tested.
- ☐ All electrical outlets on equipment handlers, nurse millwork and a/v rack location must have power.
- ☐ Permanent power must be energized.
- ☐ Ceiling speaker cutouts must be prepared.
- ☐ Wall mounts for flat panel displays and touch panels must be installed.
- ☐ All network data drops need to be installed.

MILLWORK:

- ☐ Millwork must be installed with proper venting for calculated heat loads per the KARL STORZ drawings.
- ☐ Cover plate of large junction box behind av rack has mouse hole cut in proper location.
- ☐ Facility provided carpenter must be available for any grommet placement.

BOOM EQUIPMENT:

- ☐ Boom equipment must be installed and available for cabling by the KARL STORZ team.
- ☐ Boom equipment must be powered.
- ☐ In-Light Camera boxes must be available.

OWNER FURNISHED EQUIPMENT:

- ☐ OR equipment such as C-ARMS, Ultrasound, CT Machines and Microscopes must be available for testing and integration.
- ☐ Computers and workstations must be available for cable integration and testing.
- ☐ Videoconference telephone or network connections must be live.
- ☐ If applicable, all lighting control equipment must be installed and tested by the facility.

ENVIRONMENTAL CONDITIONS:

- ☐ Site is safe to work.
- ☐ If site has specific attire requirements and/or PPE requirements, the customer must provide access to appropriate attire and PPE for the crew.
- ☐ The OR must be clean and dust free.
- ☐ Delivery access must be available.
- ☐ Area to store all KARL STORZ materials for duration of installation identified.
- ☐ Trash disposal must be available.
- ☐ All safety training must be scheduled prior to arrival.
- ☐ Any sub-contractor conflicts need to be addressed and conflicting schedules need to be addressed to minimize KARL STORZ downtime.
- ☐ Adequate working hours must be available to the product deployment crew.

Use this document to ensure that all teams and spaces are aligned for the deployment of your KARL STORZ integrated operating room. Failure to meet readiness can impact your installation schedule.

Thank you for your partnership.

KARL STORZ

97208100 OR1 2 1.0 us 03/2022/SE-E-US

The designs shown on these drawings are planning concept designs only, are not drawn to scale, are not drawn as architectural plans or detailed engineering drawings, do not represent full detail working designs, and do not represent or incorporate detail structural or engineering analysis. These drawings are provided "as-is" and are intended to be used only as planning concept guides, and not for any other purpose. All warranties and representations of any kind, whether expressed implied or statutory, including warranties of merchantability, fitness for a particular purpose, or non-infringement, are hereby disclaimed in any manner other than as herein intended. Any recipient of these drawings hereby agrees to indemnify K+S Corp. against any and all claims, liability, damages and costs (including attorneys' fees) arising out of, or resulting from, any use of these designs or drawings other than as herein intended.

FOR COORDINATION ONLY - NOT FOR CONSTRUCTION